



Friends™

41721





We're switching from plastic to paper-based packaging. That's why you might find a mix of paper and plastic in our boxes!

Wir stellen von Kunststoffverpackungen auf Verpackungen auf Papierbasis um. Möglicherweise findest du deshalb sowohl Papier als auch Kunststoff in unseren Boxen!

Nous abandonnons progressivement les emballages en plastique au profit d'emballages à base de papier. Il est donc possible que vous trouviez à la fois du papier et du plastique dans nos boîtes !

Stiamo passando dagli imballaggi di plastica a quelli basati su carta. Ecco perché potreste trovare un mix di carta e di plastica nelle nostre confezioni!

Estamos sustituyendo las bolsas de plástico por bolsas con base de papel. ¡Por eso, puede que encuentres una mezcla de papel y de plástico en nuestras cajas!

Estamos a substituir as nossas embalagens de plástico por embalagens à base de papel. Por isso poderá encontrar um misto de papel e plástico nas nossas caixas!

Átállunk a műanyagról a papír alapú csomagolásra. Ezért előfordulhat, hogy a dobozainkban papír és műanyag zacskót egyaránt találsz!

Mēs pārejam no plastmasas iepakojuma uz iepakojumu, kurā izmantots papīrs. Tāpēc mūsu kārbās var būt gan papīra, gan plastmasas daļas.

Trecem de la ambalajele din material plastic la ambalaje pe bază de hârtie. Iată de ce s-ar putea să găsești un amestec de hârtie și material plastic în cutiile noastre!

我们正在从塑料包装向纸基包装过渡。这就是为什么你可能会发现我们的包装盒中同时出现塑料和纸质材料！

[LEGO.com/sustainable-packaging](https://www.lego.com/sustainable-packaging)



乐高®拼搭指引



LEGO® Building Instructions



Download on the
App Store



GET IT ON
Google Play



腾讯应用宝
安卓应用商店

Check for compatibility
Kompatibilität prüfen
Vérifier la compatibilité
Controlla la compatibilità
Comprueba tu compatibilidad
Verificar a compatibilidade
Ellenőrizd a kompatibilitást
Pārbaudīt saderību
Verificarea compatibilității
检查兼容性

[LEGO.com/devicecheck](https://www.lego.com/devicecheck)

Apple and the Apple logo are trademarks of Apple Inc.
Google Play and the Google Play logo are trademarks of Google LLC.
Tencent and the Tencent logo are trademarks of Tencent Inc.

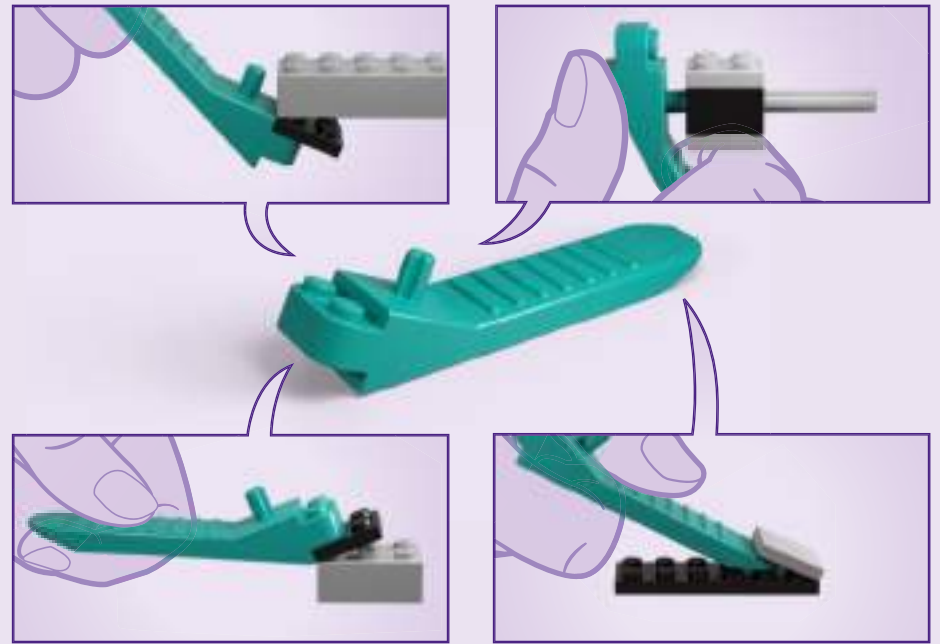

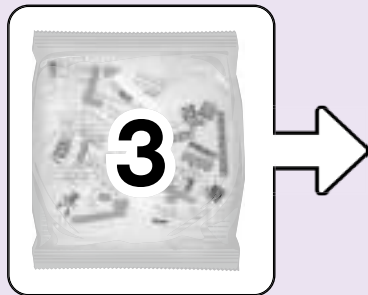
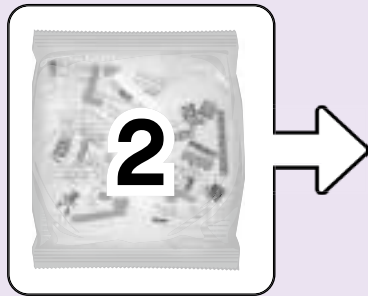
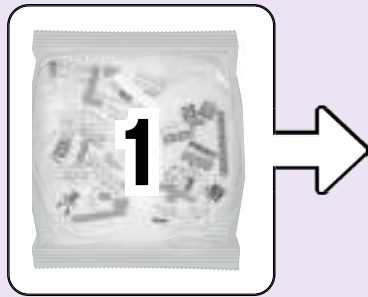

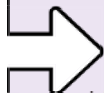
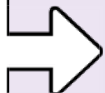
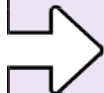
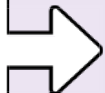





1



2





3

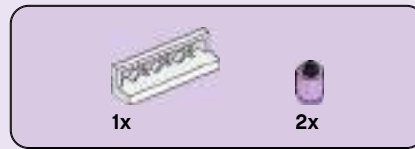

4



5





6

1



2



3

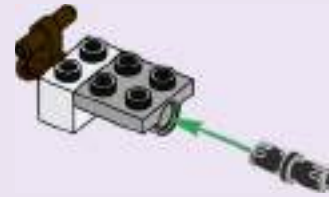

4



5



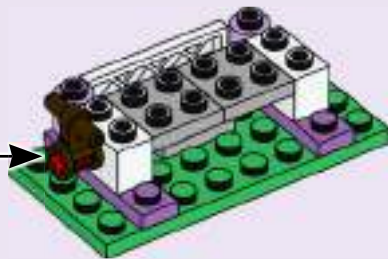

7

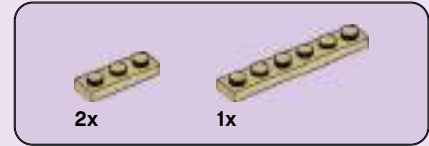

8





9



10

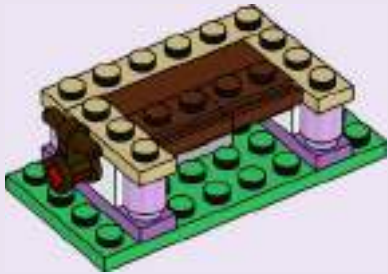

11



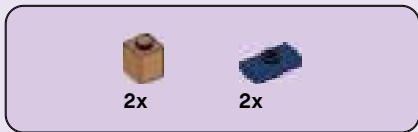

12

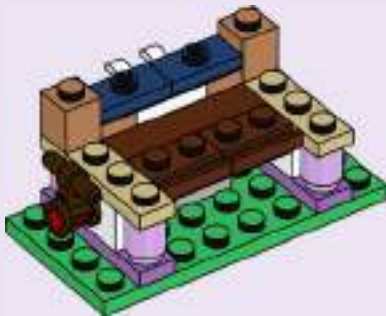

13

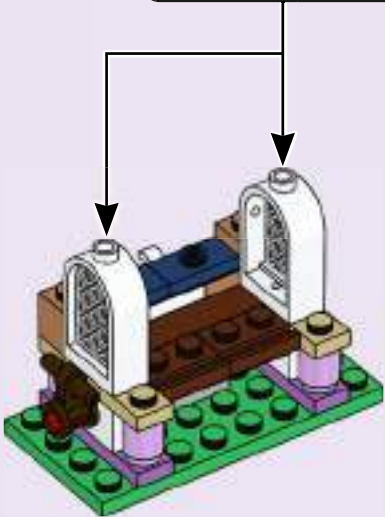
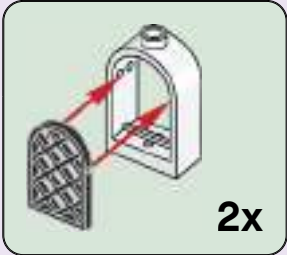



4x

14

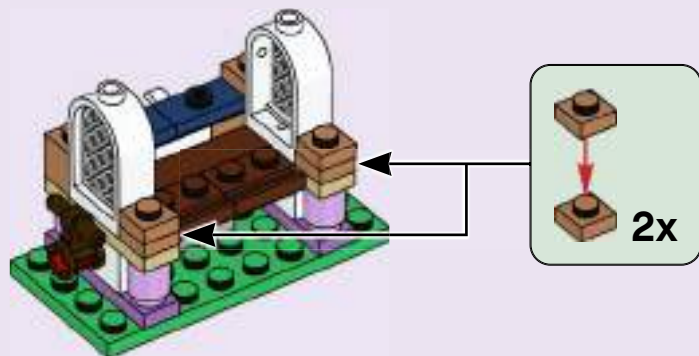

1x

15

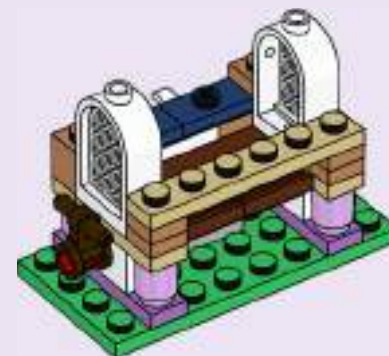



16



17





18



19



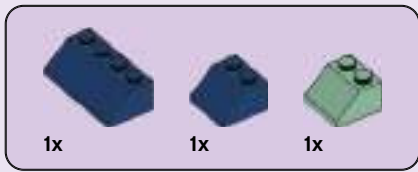

20



21



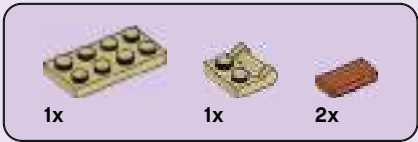

22

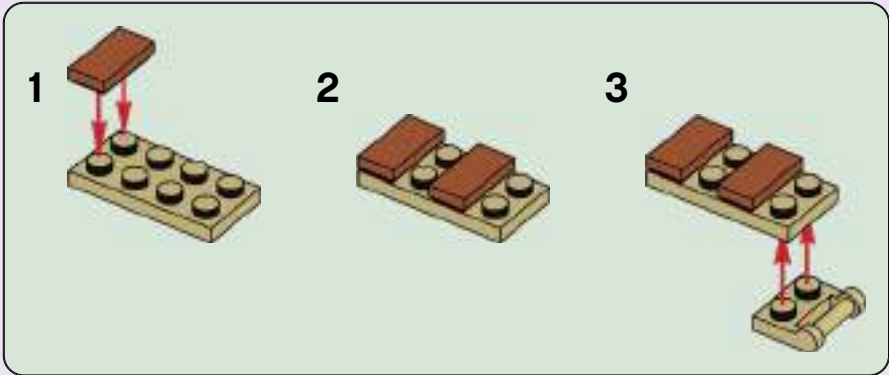



3x

23



1x



1x

24



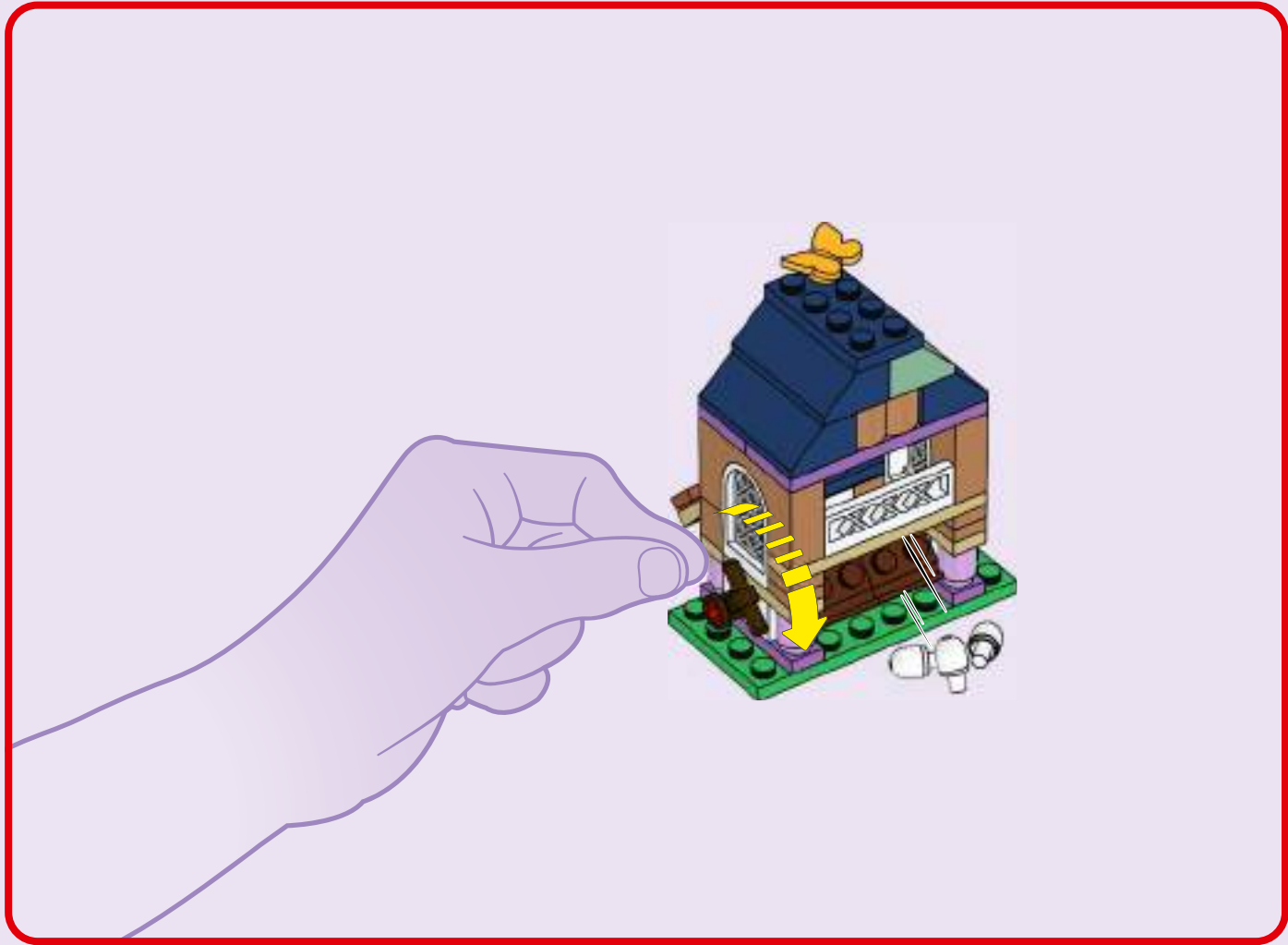



1

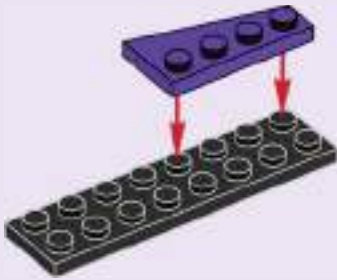

2

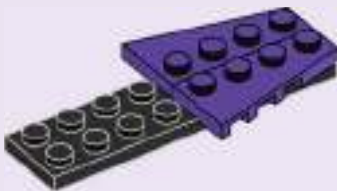

3

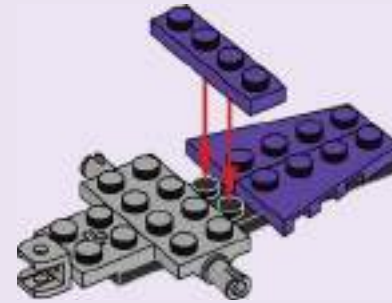

4

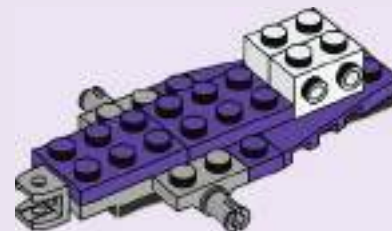



5

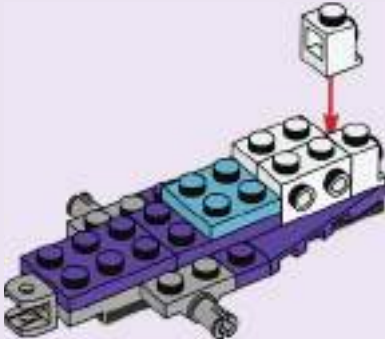

6

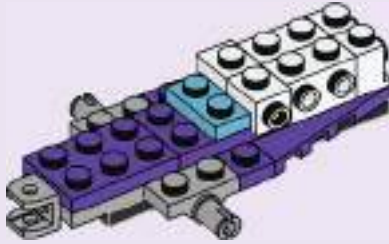

7

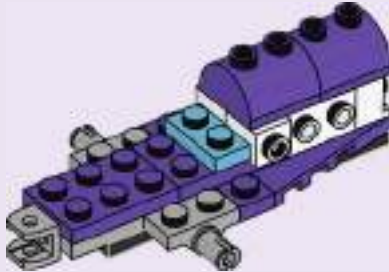



1x

8

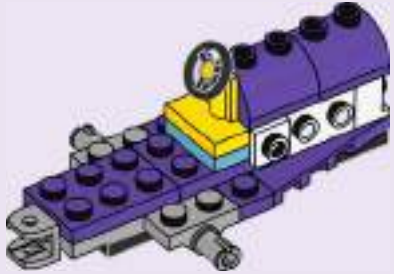

1x



1x

9

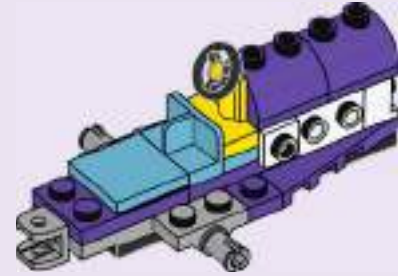

1x



2x

10

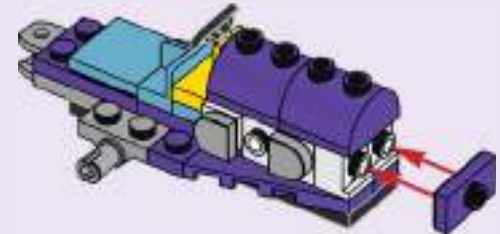



1x



1x



2x

11

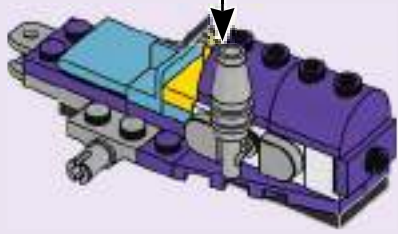
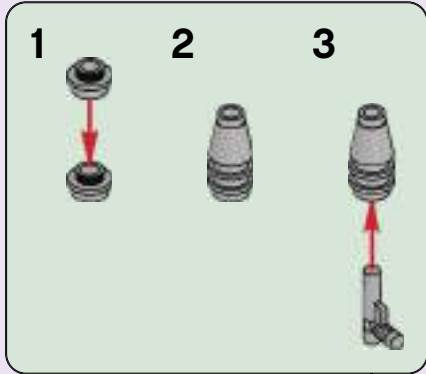

1x



1x



1x

12

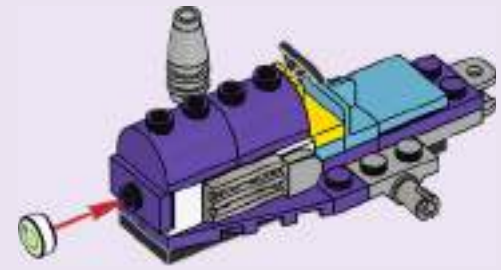
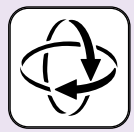

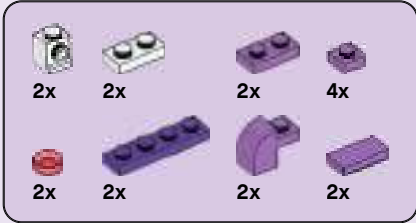

13

1



2

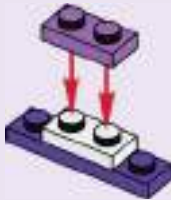

3



4

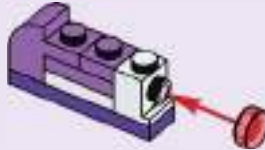

5

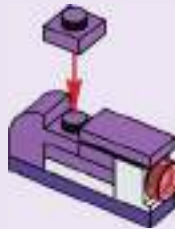

2x

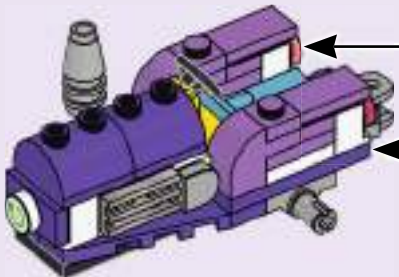



14

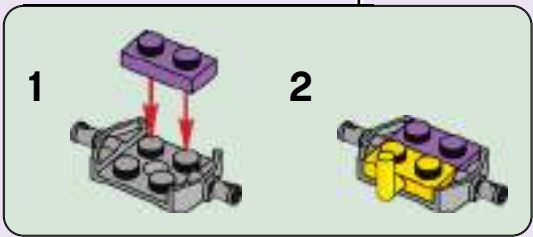
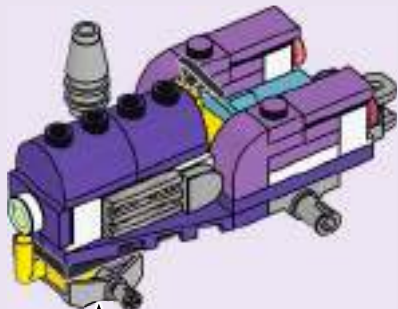

15

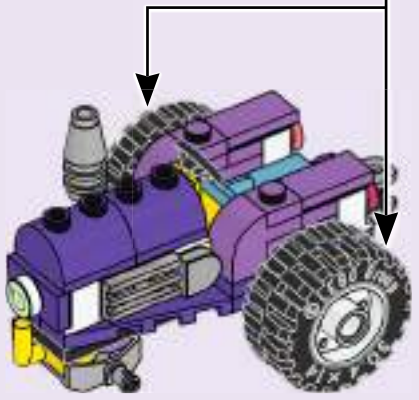
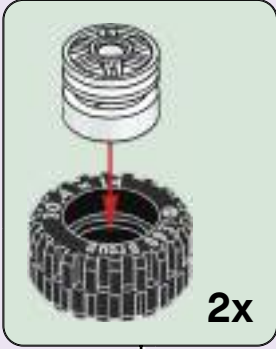



16

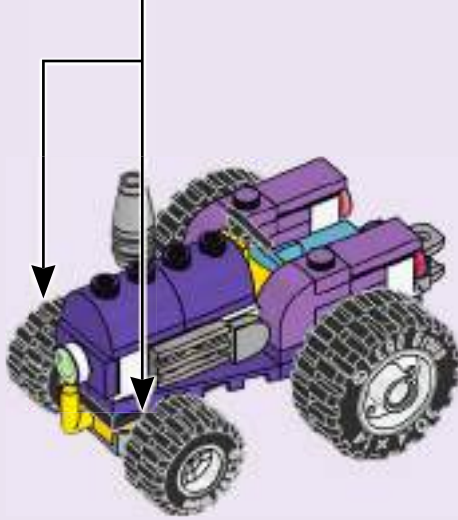
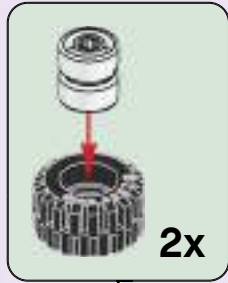

17

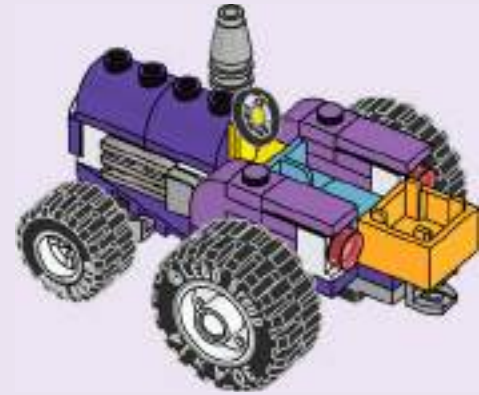



1x



1x

18

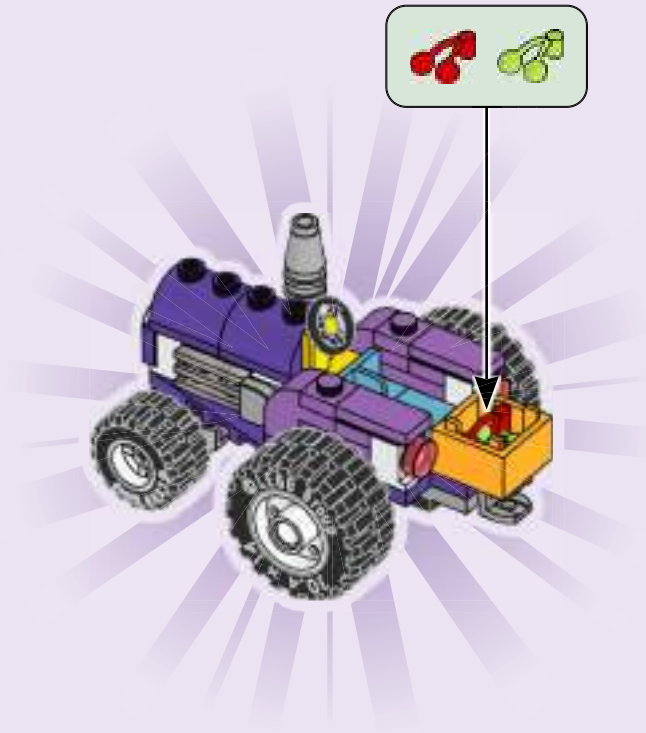



19

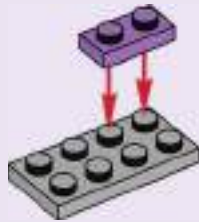

20



21

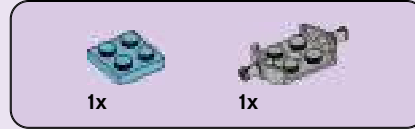

22

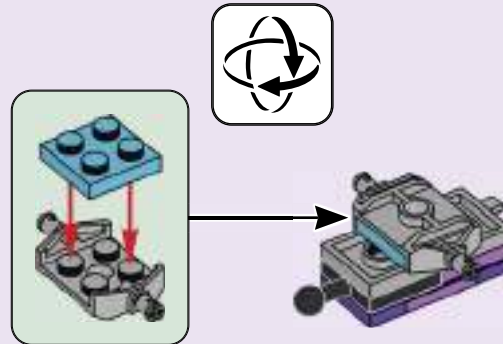



23

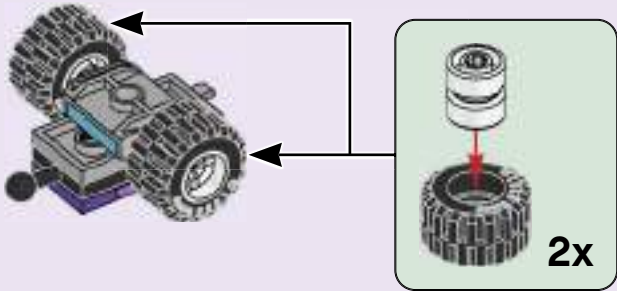

24



25

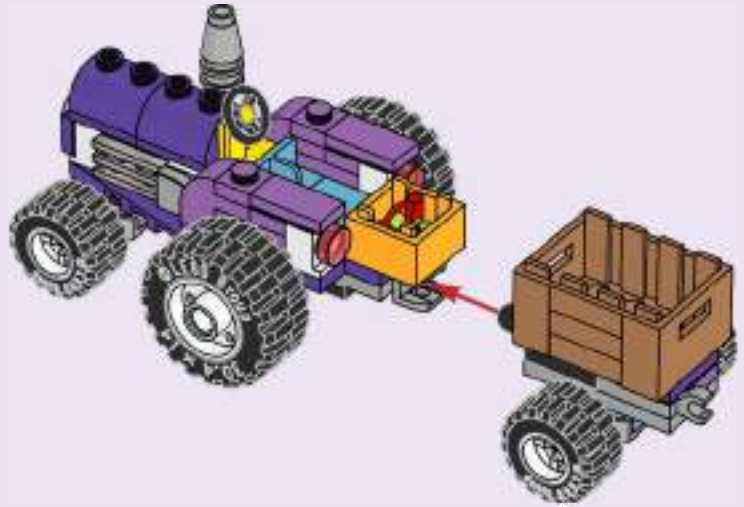



26

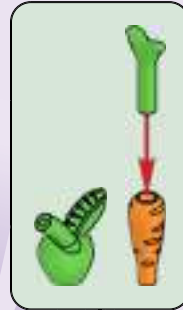

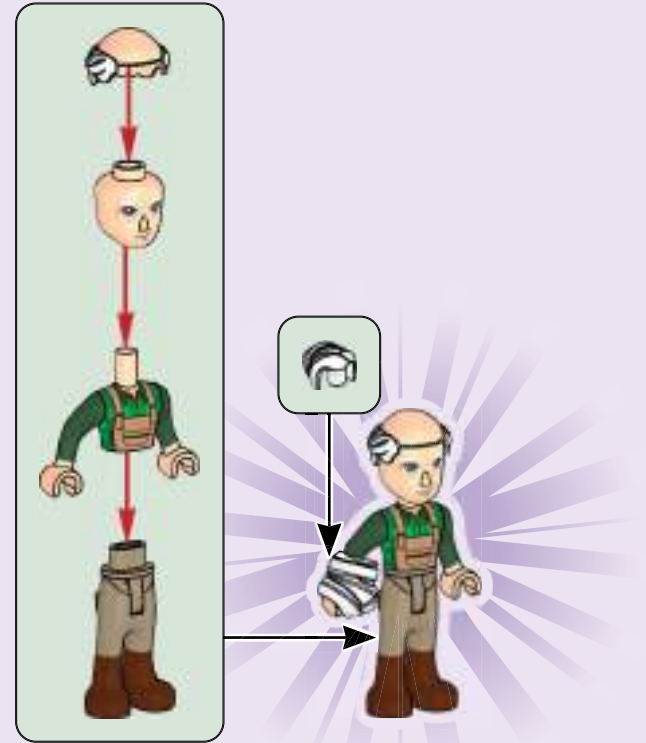

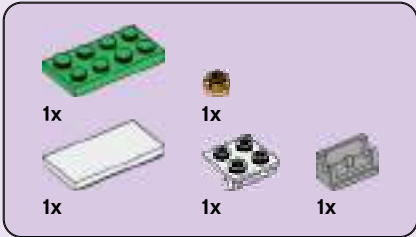

1



2



3

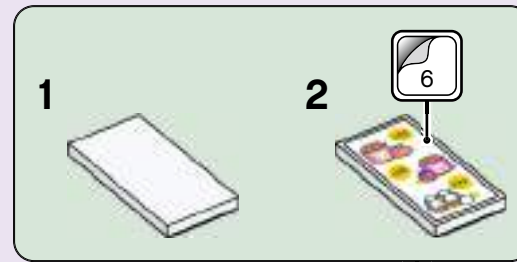

4





1



2

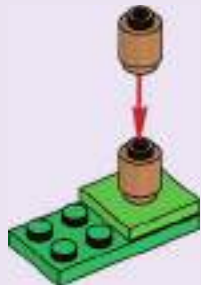

3

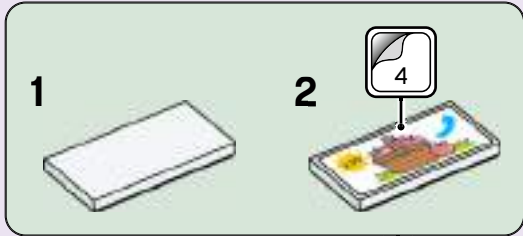

4





1



2



3





4



5

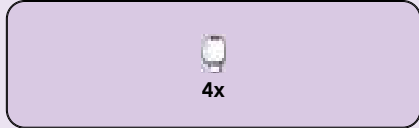

6





7



8

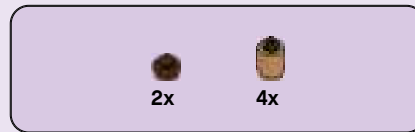

9

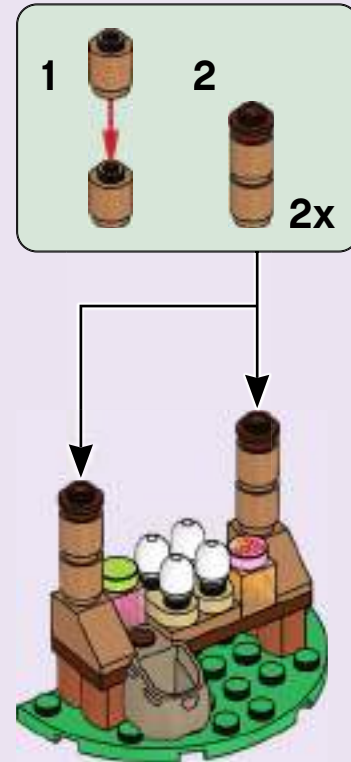



10

1

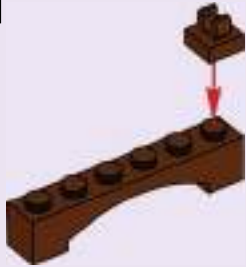

2



3

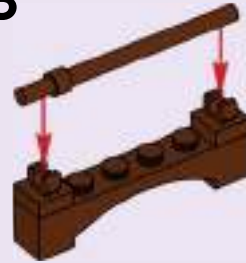



11

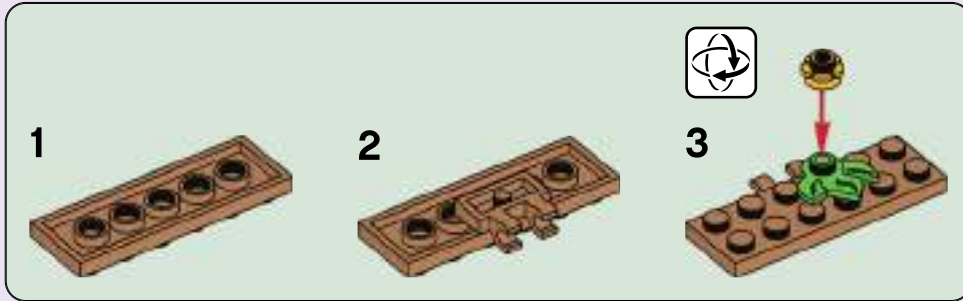

12



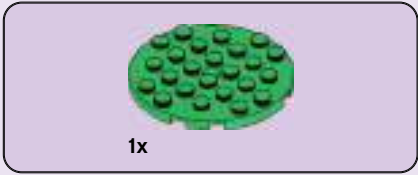

1



2

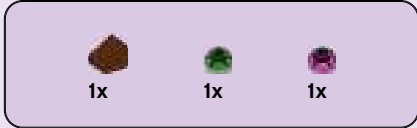

3

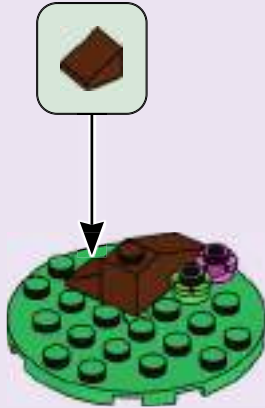



4

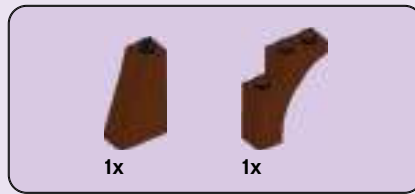

5



6





7

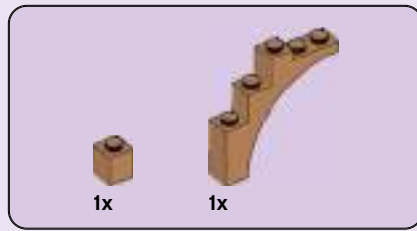

8

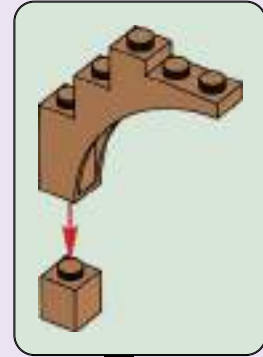



9



10

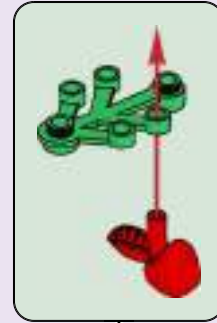



1x

11

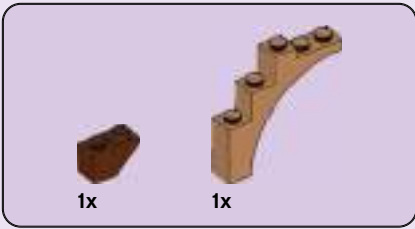

1x

1x

12





13

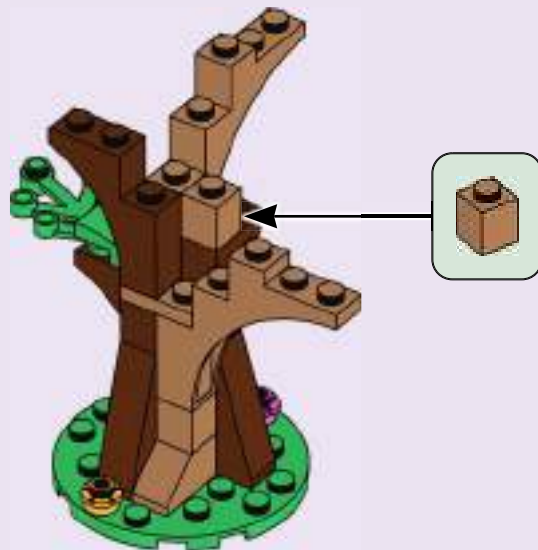

14





1x

15



2x

2x

16



2x

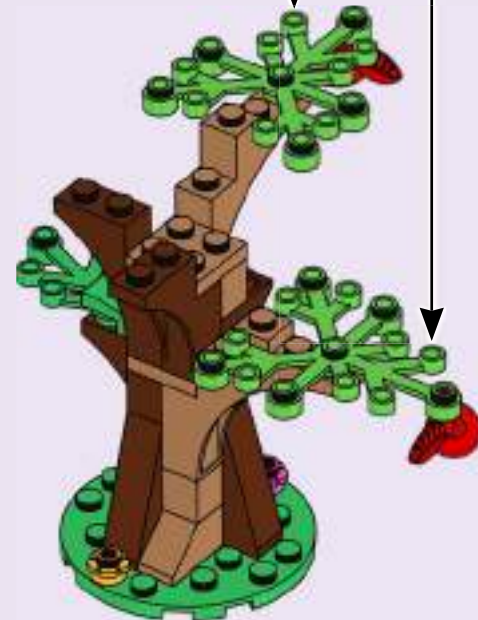



17

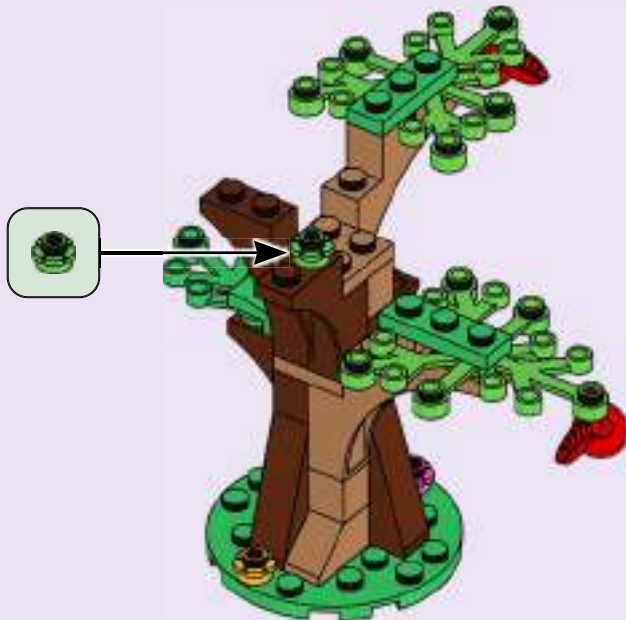

18

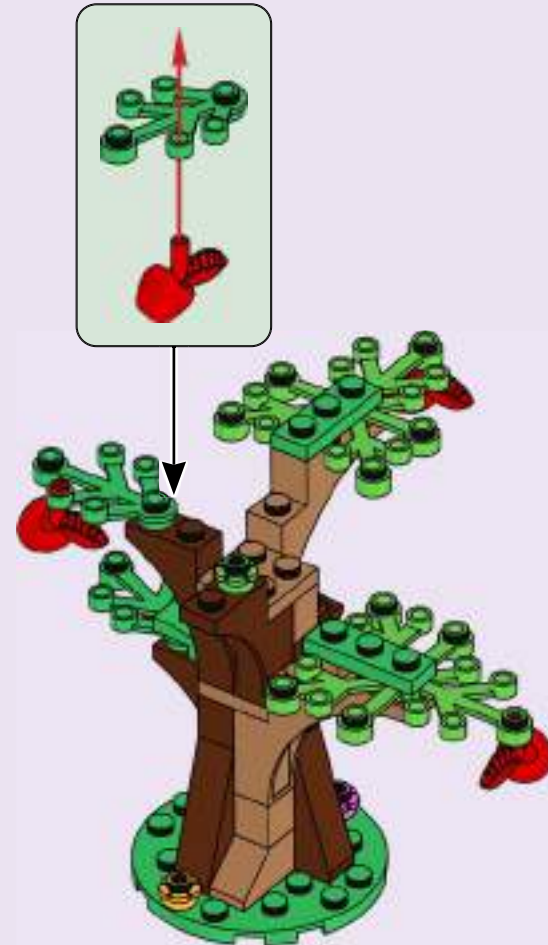

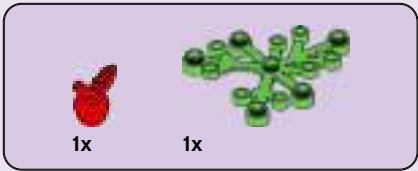

19

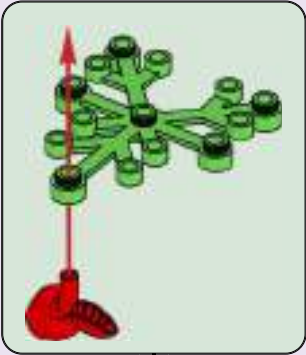

20



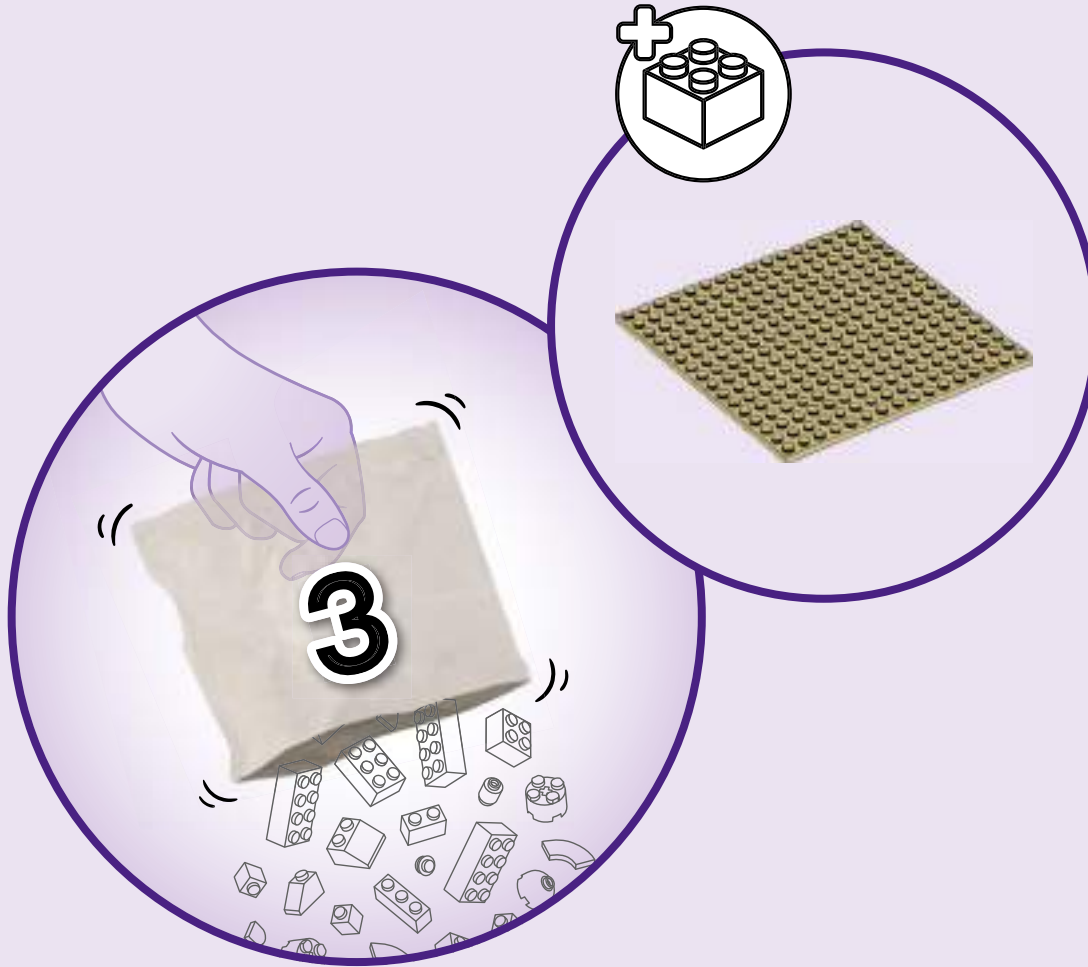

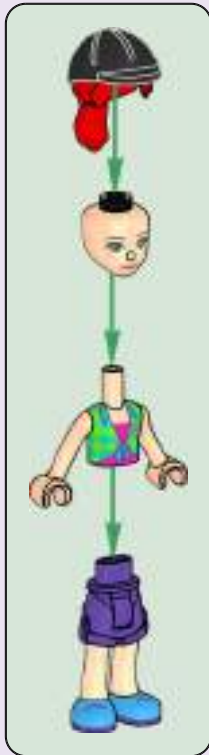
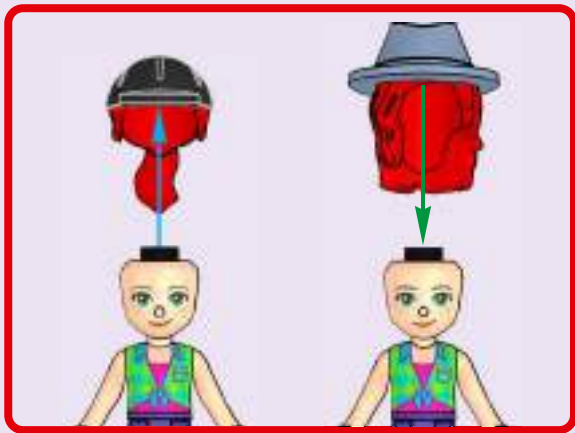

1



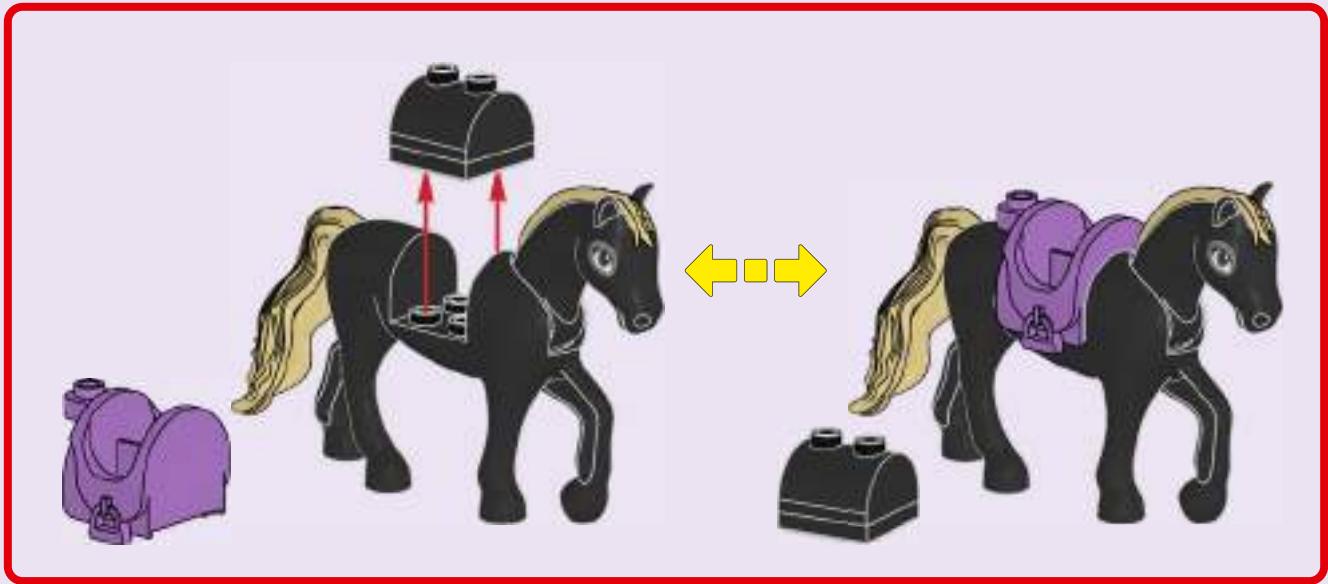

2

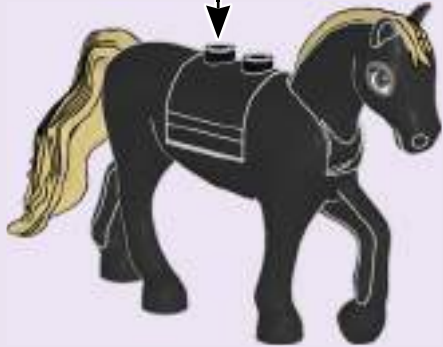

3



4

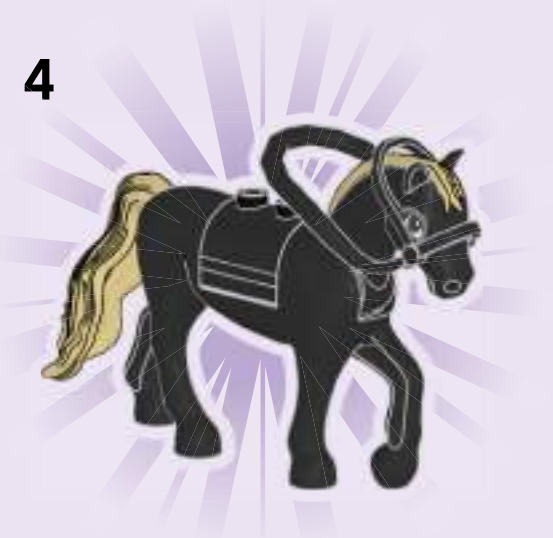



1

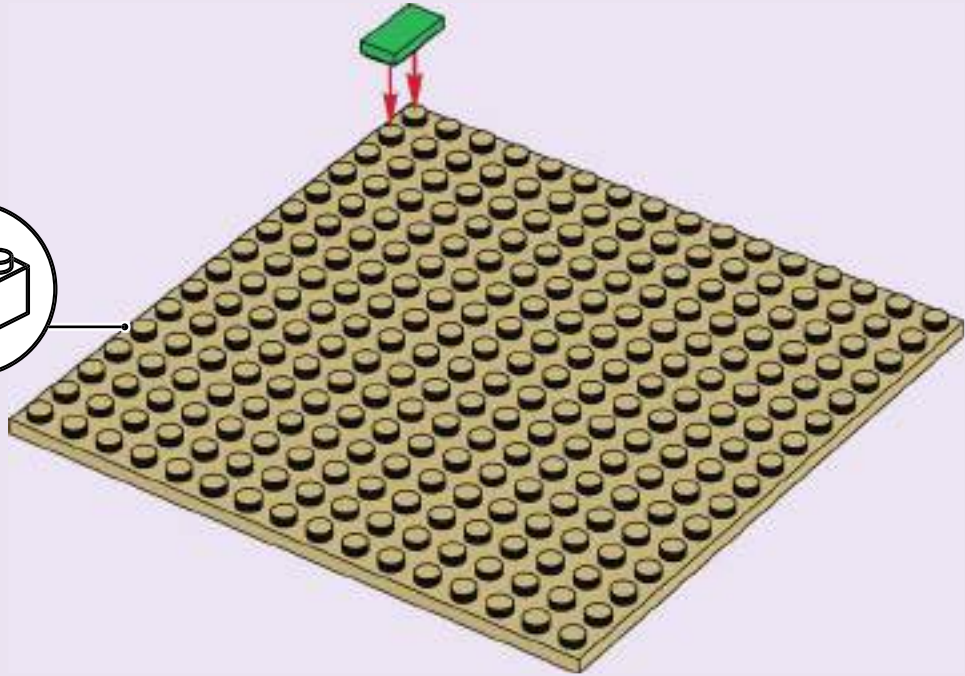
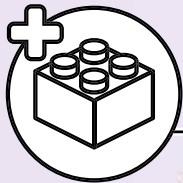

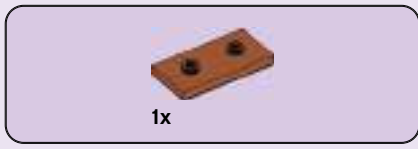

2

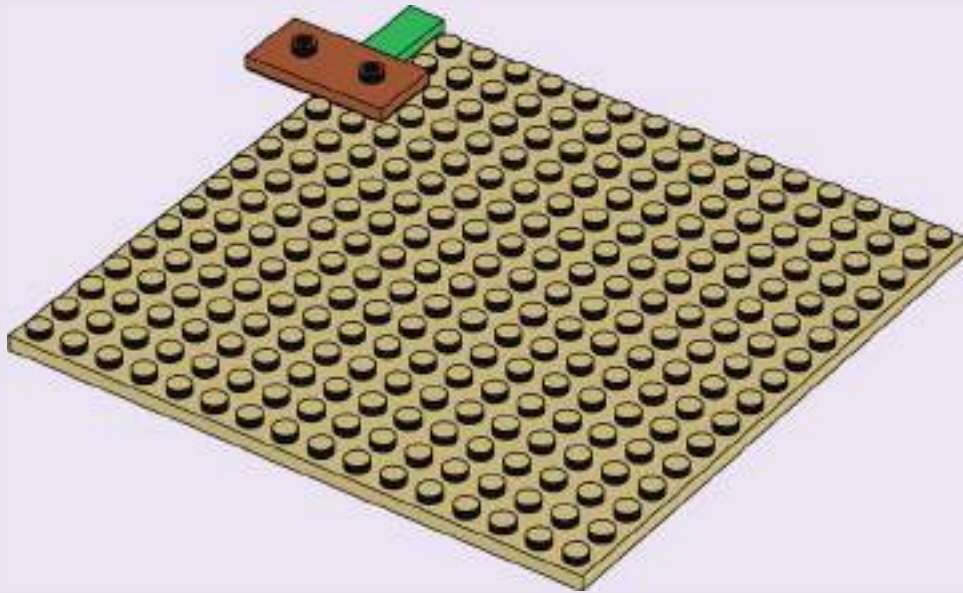

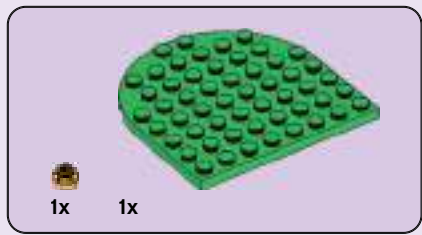

3

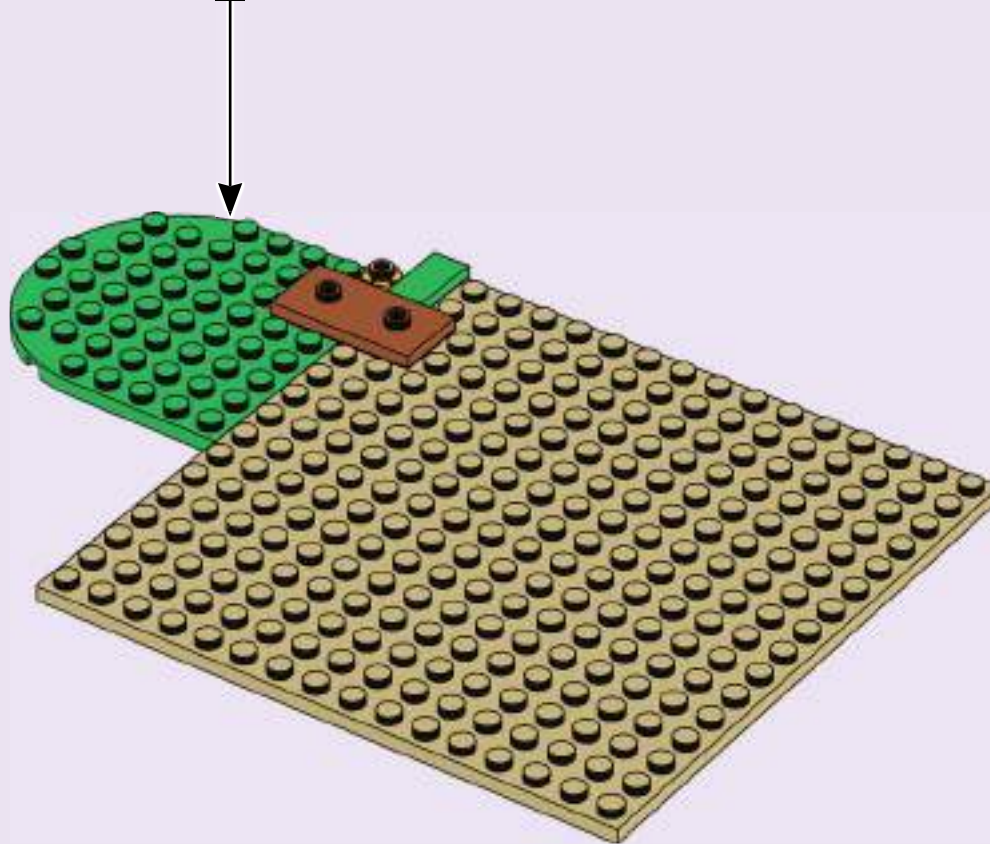
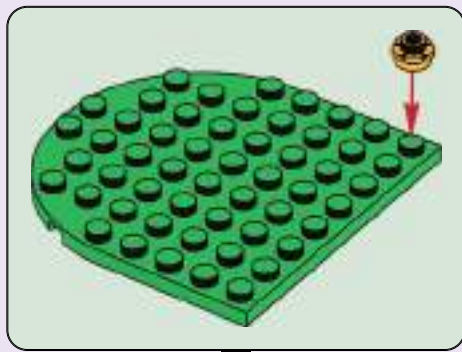



4



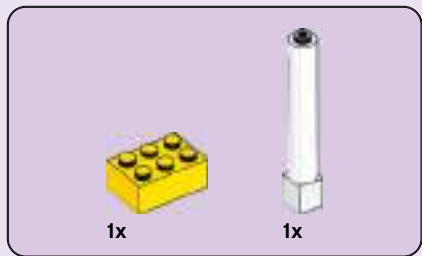

5

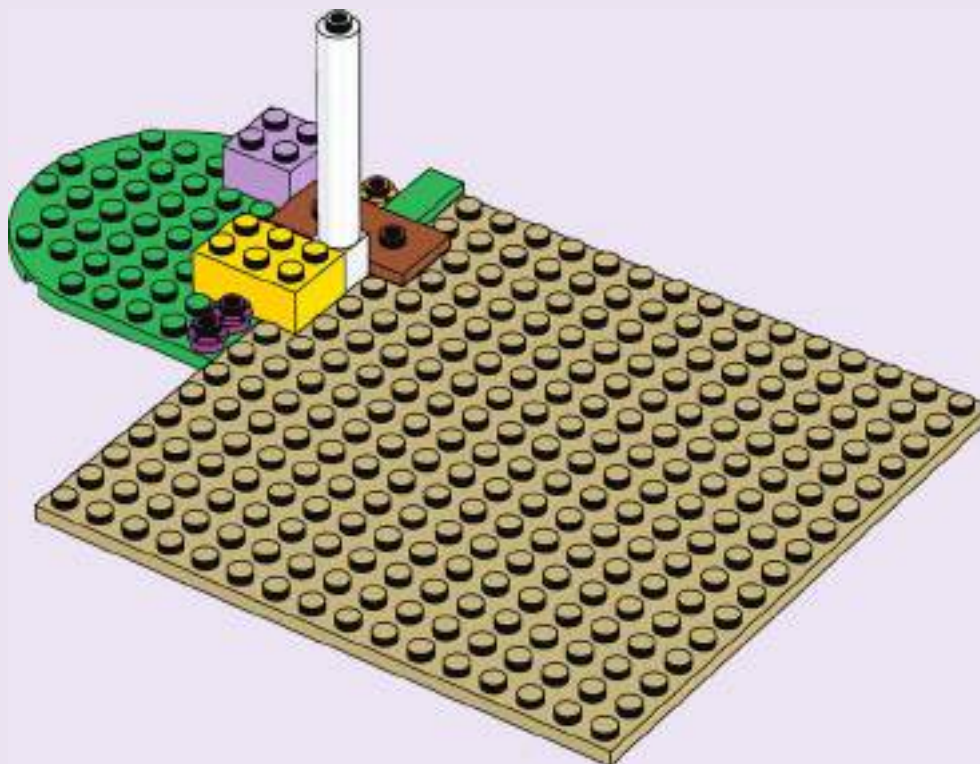



6





7

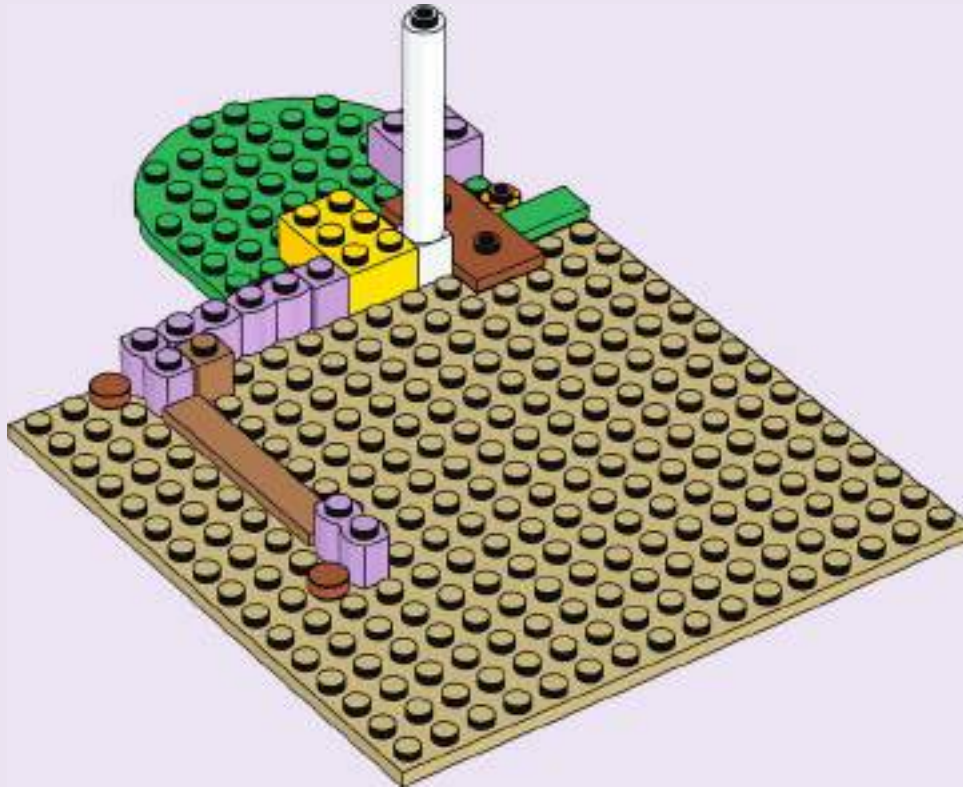



1x



6x

8



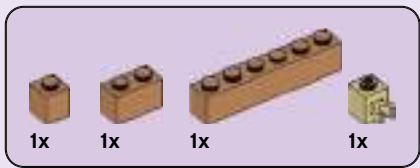

9



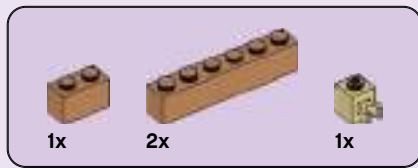

10



2x 1x

11

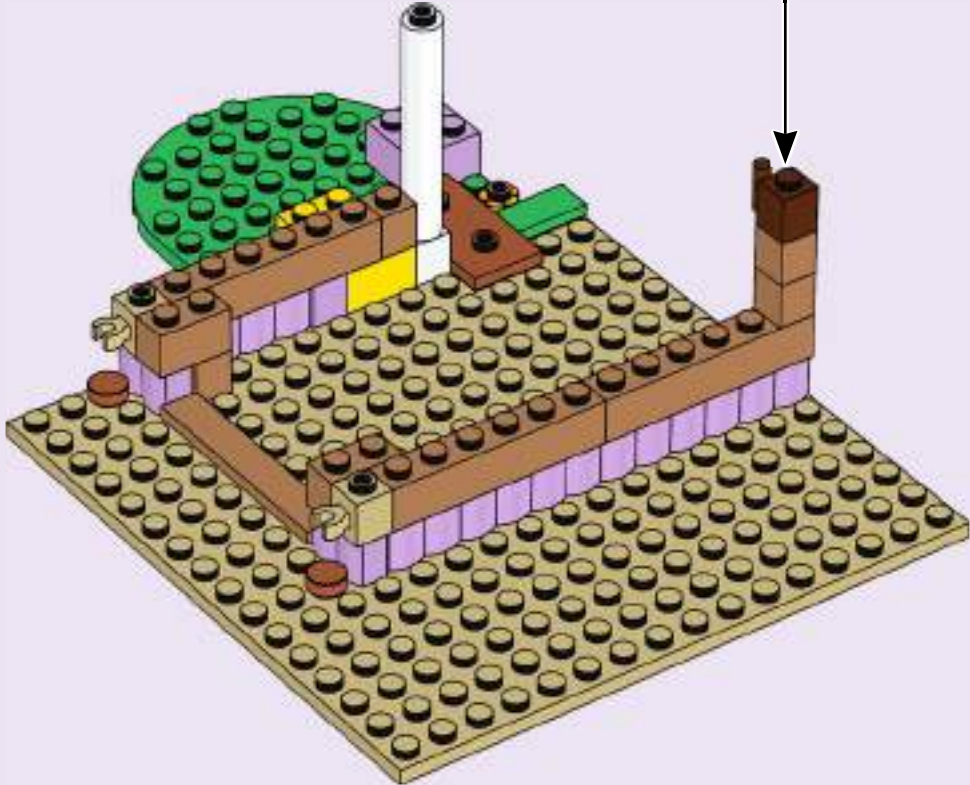
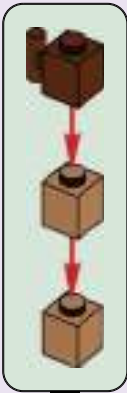

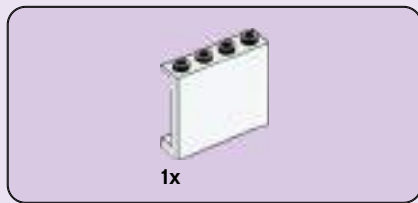

12

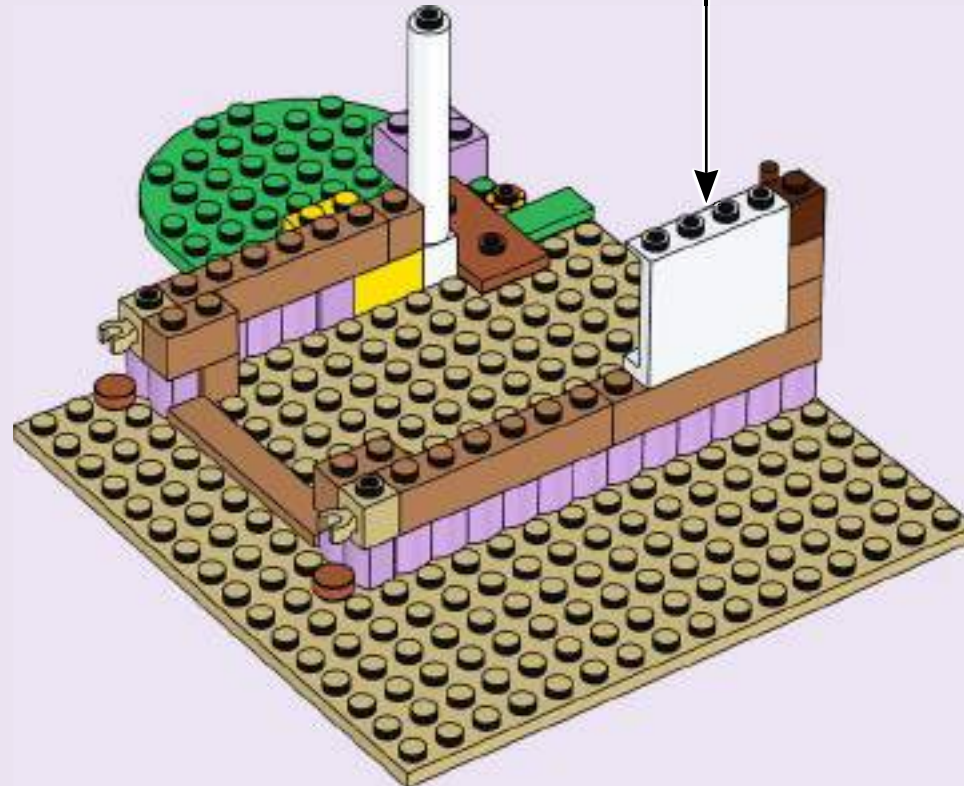
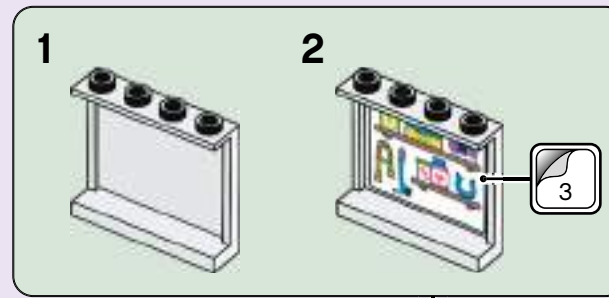



6x

13

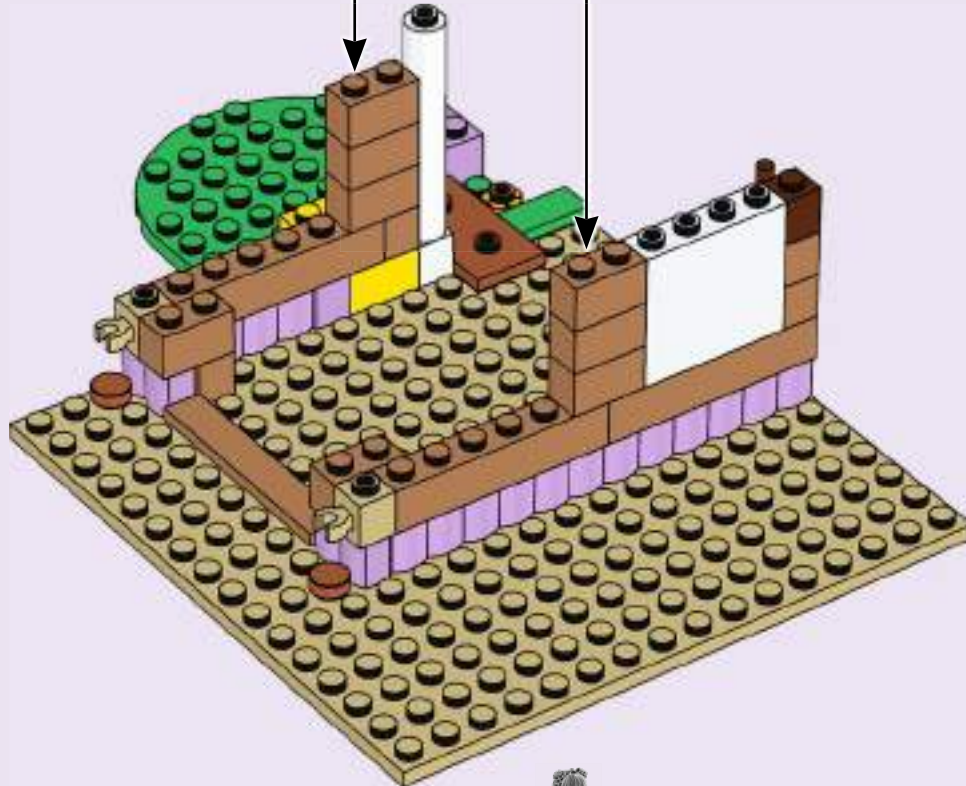
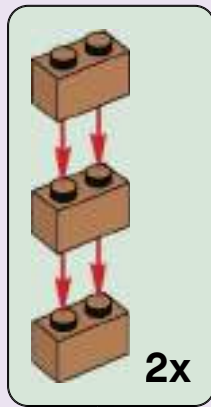

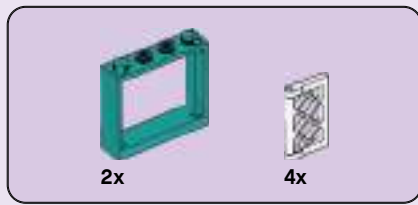

14

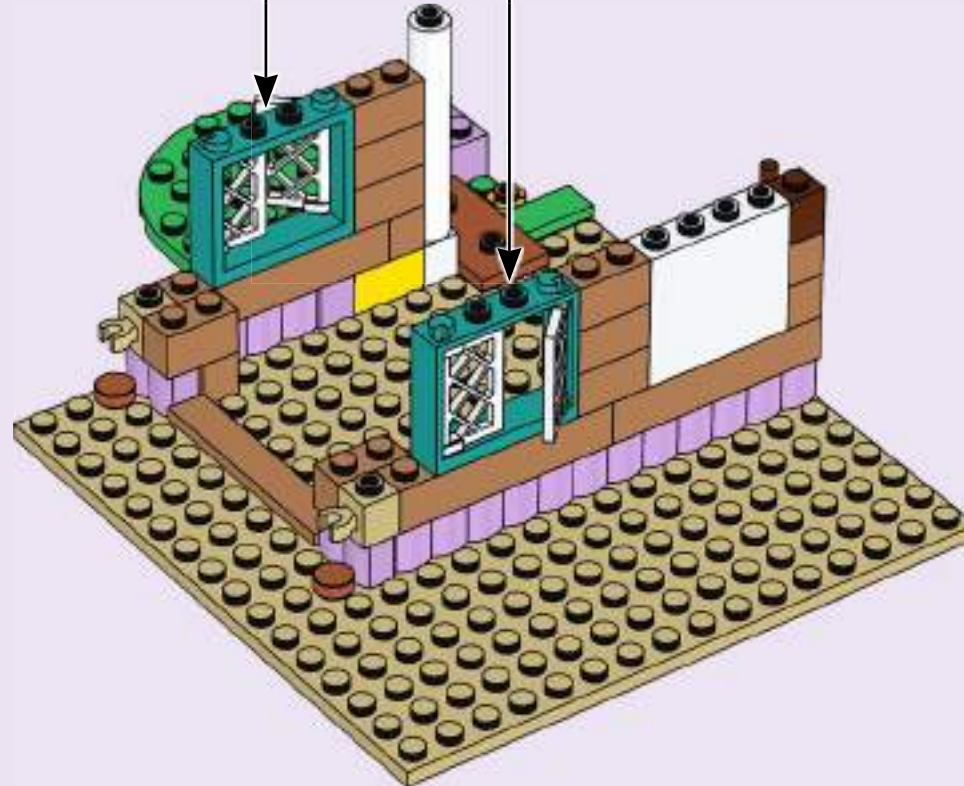
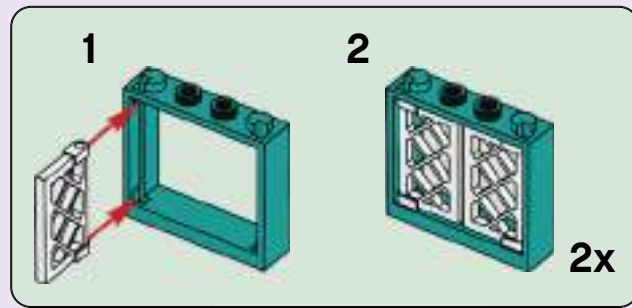



2x

15

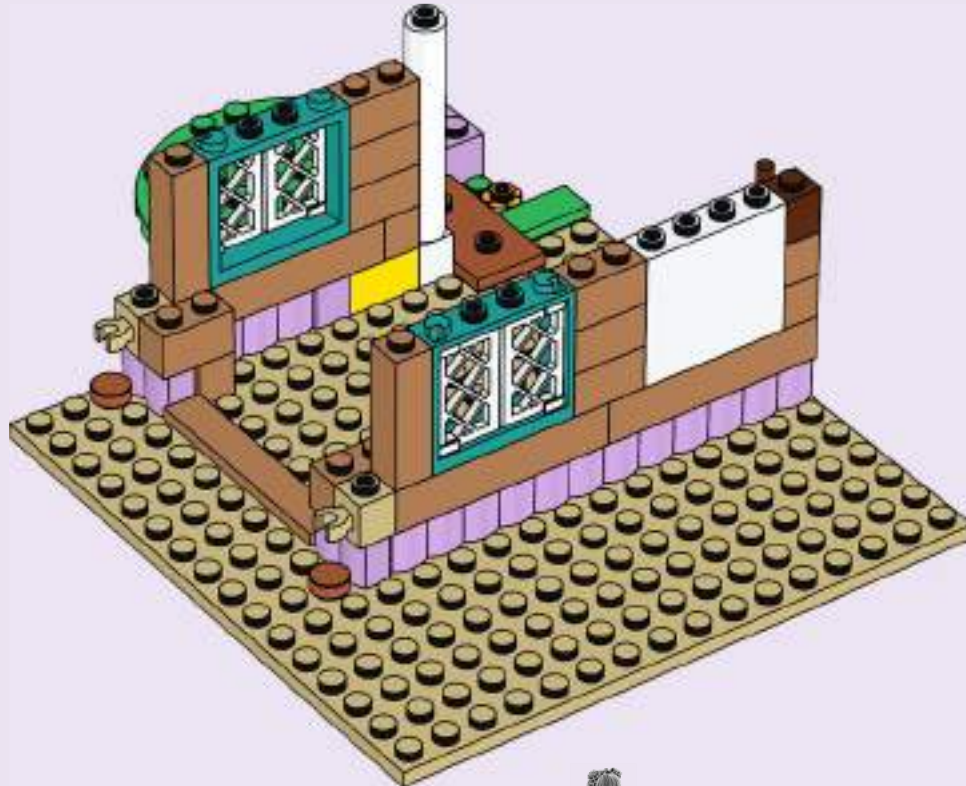



2x

17

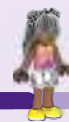
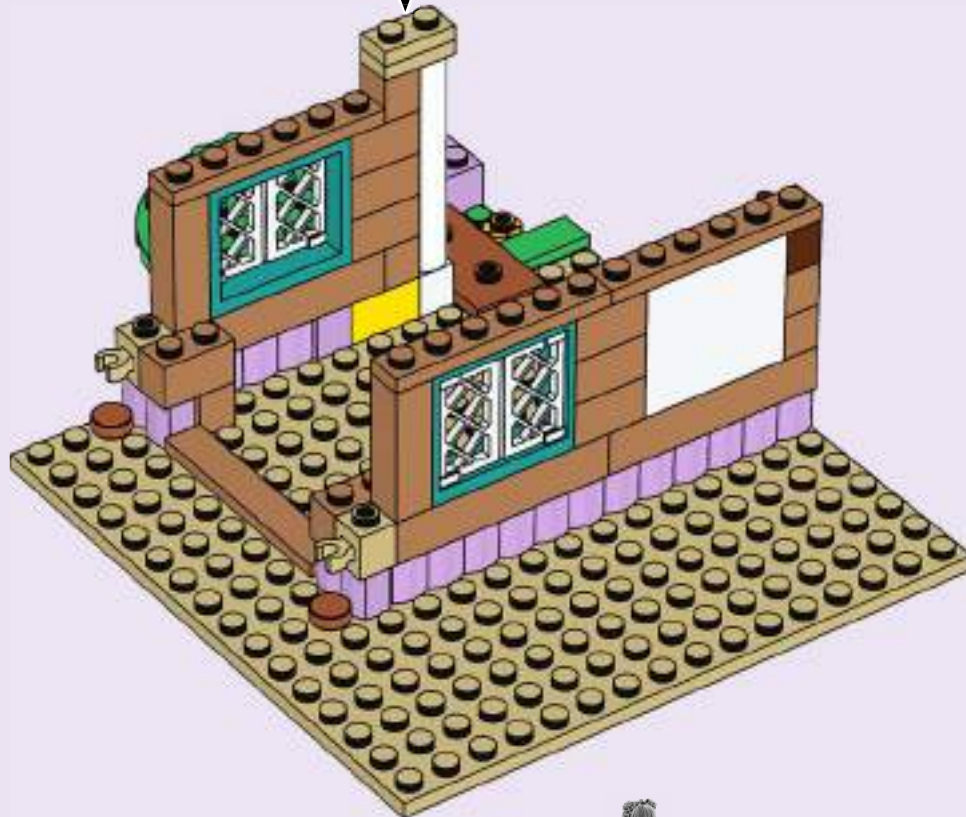
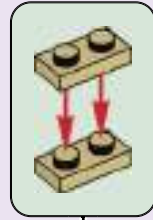



2x

18

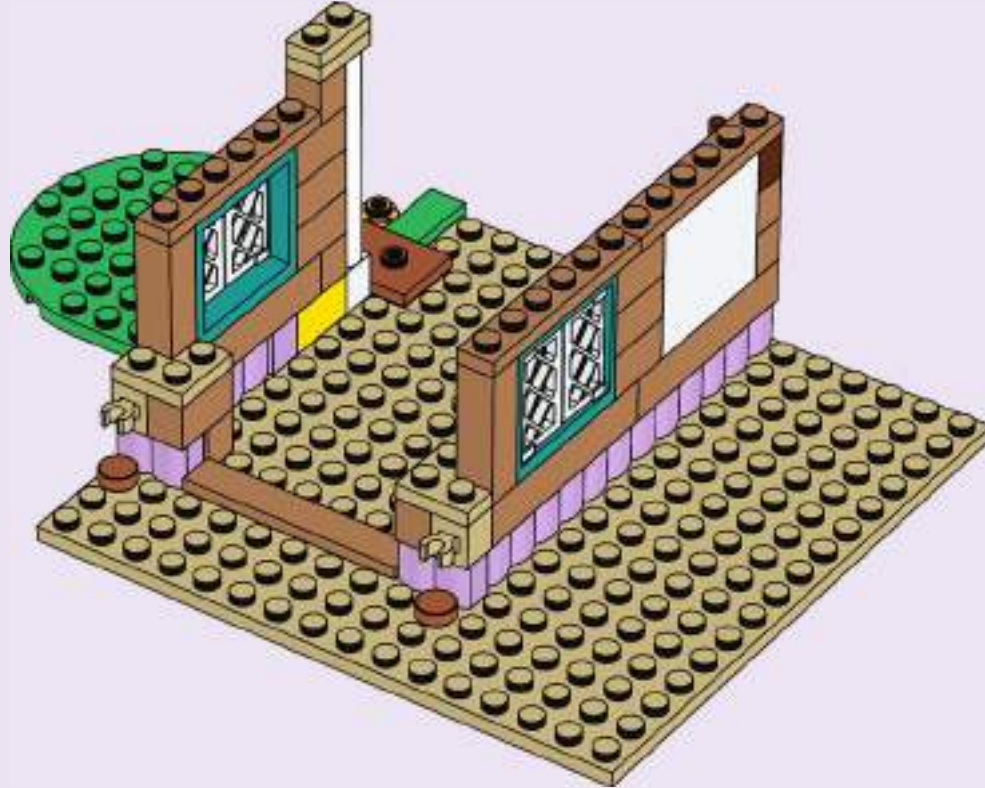



2x

19

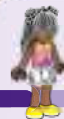
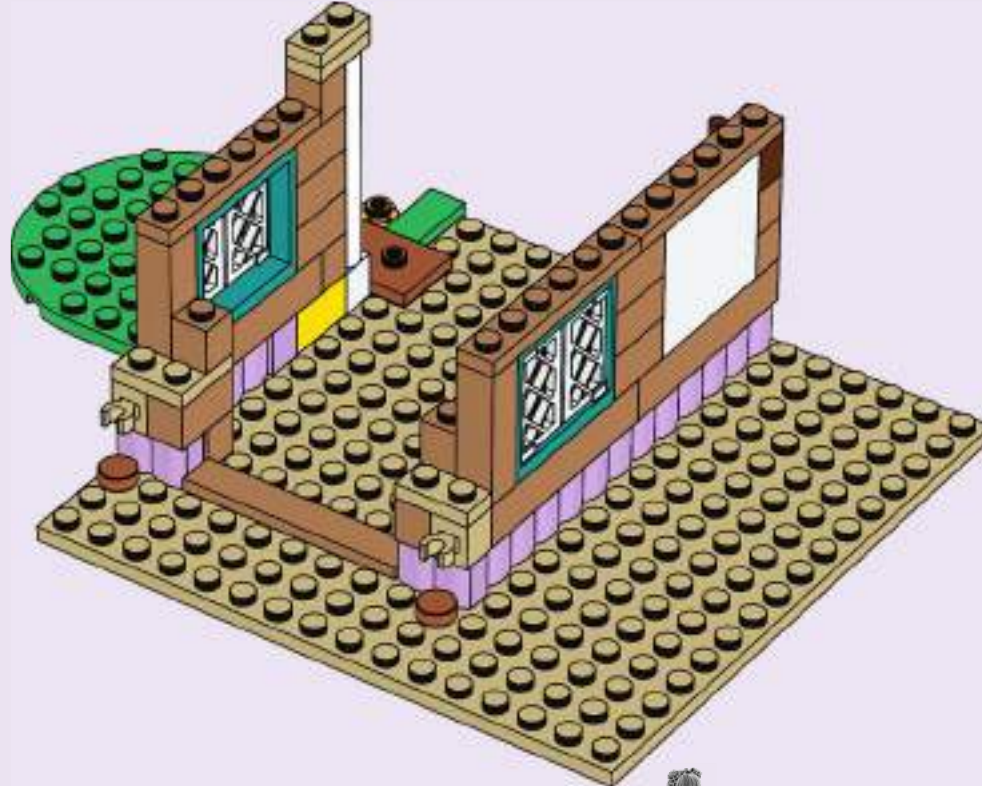



2x



2x

20

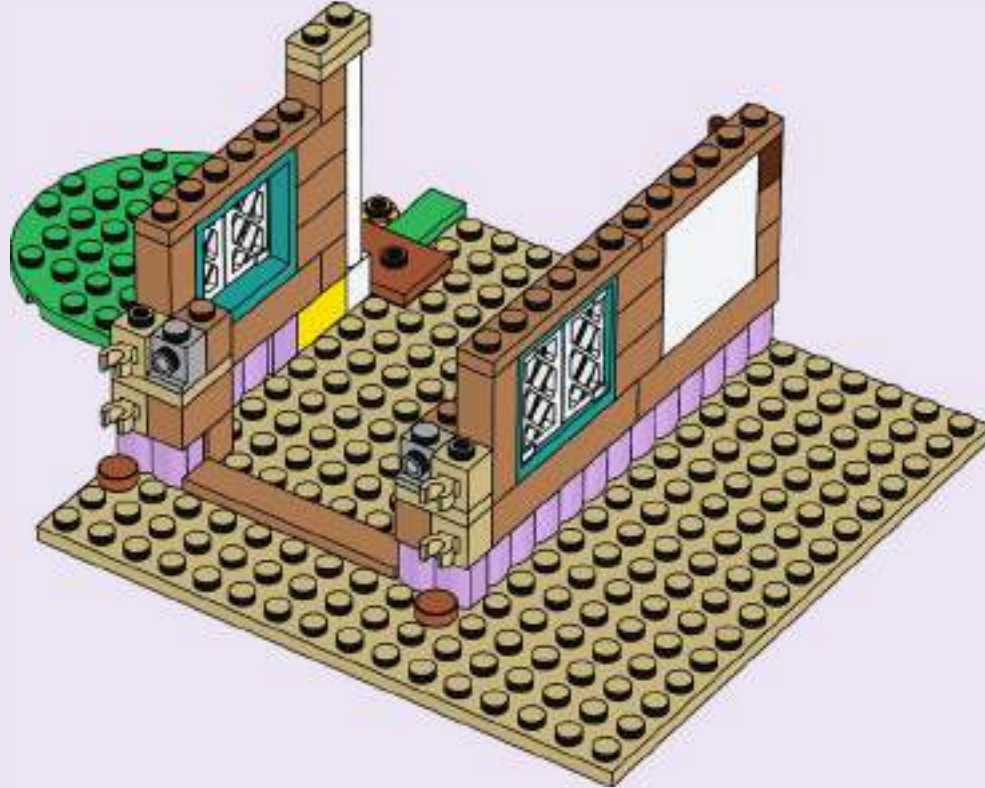



2x

21

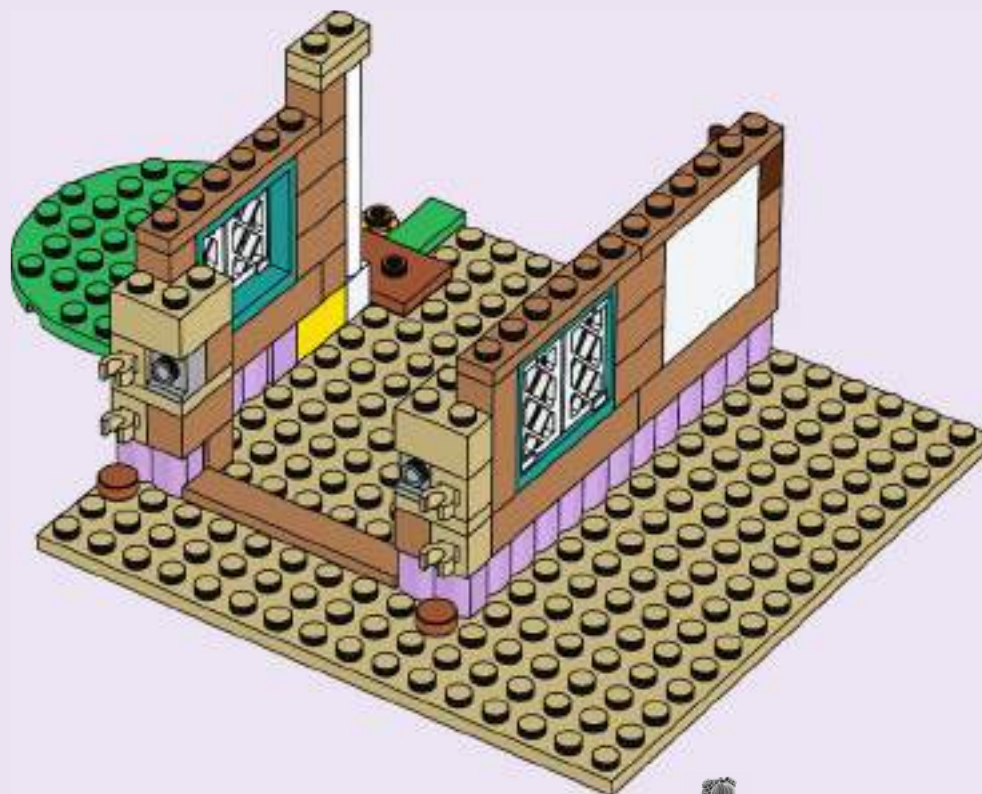



2x

22

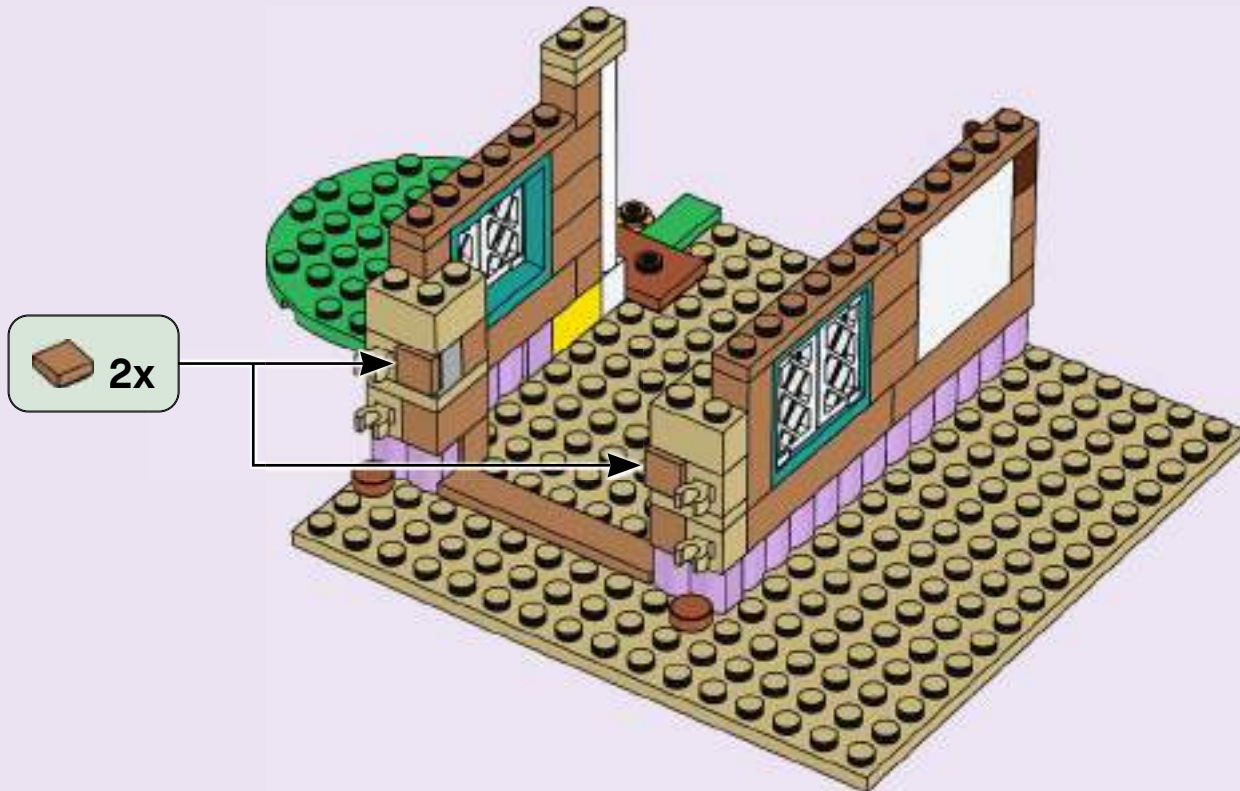



2x



2x

23

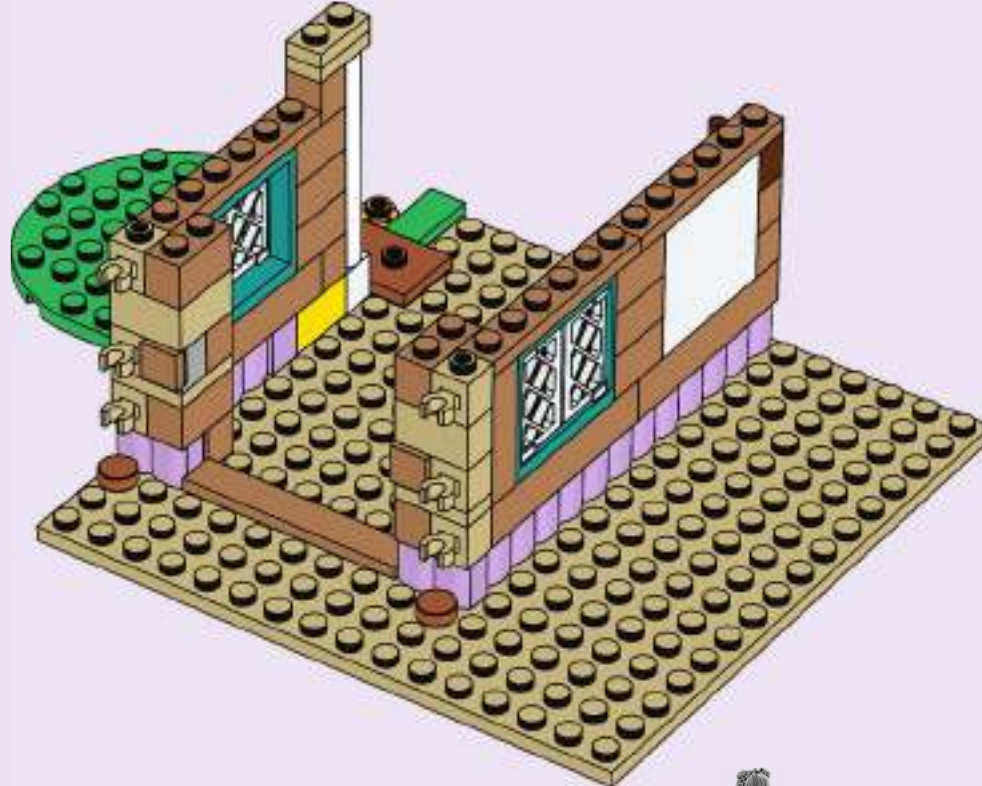



24





25



26



27

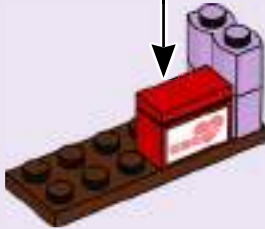
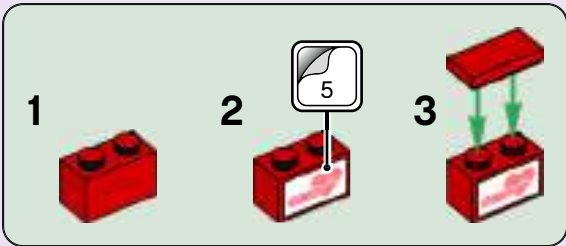

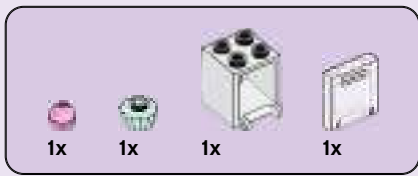

28

1

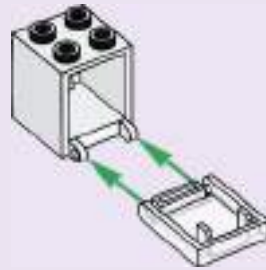

2

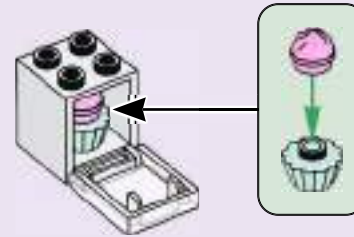



2x

29



1x



1x

30



1x



2x

31



1x



1x



1x

32



33

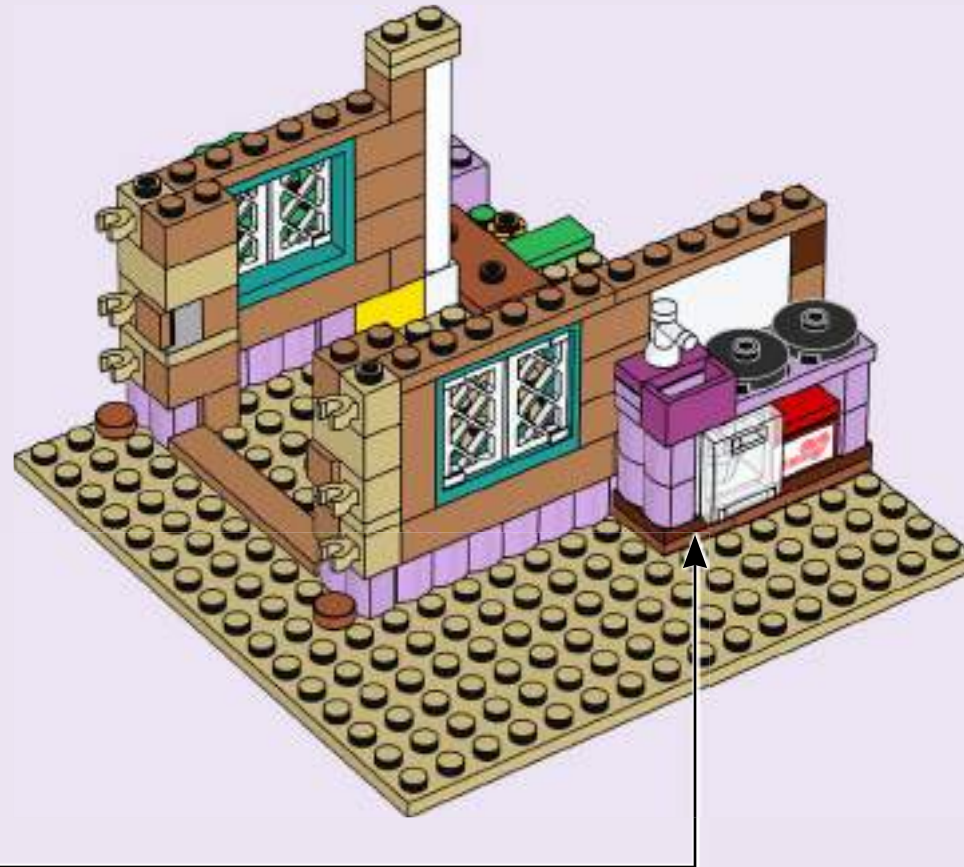

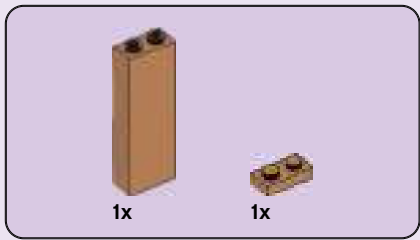

34

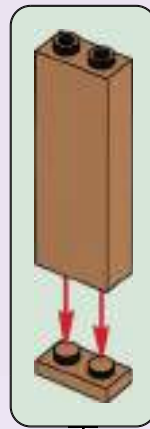



35



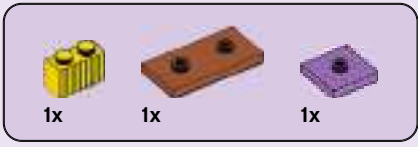

36





37

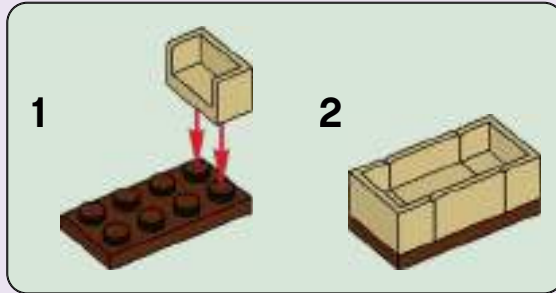



38

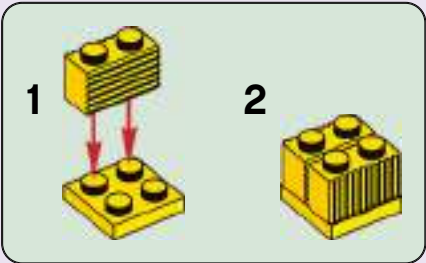



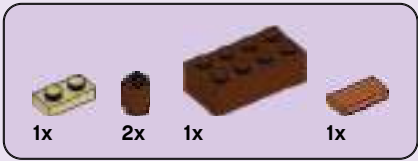

39

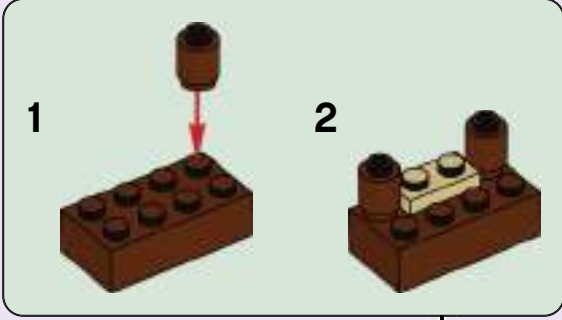

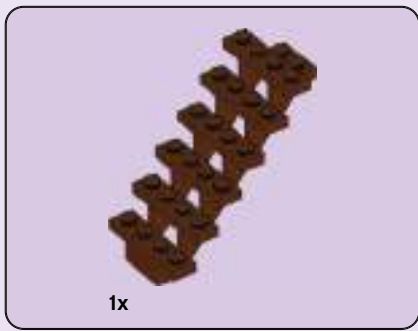

40





41



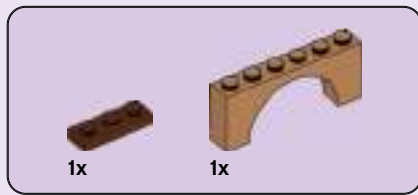

42





2x

43



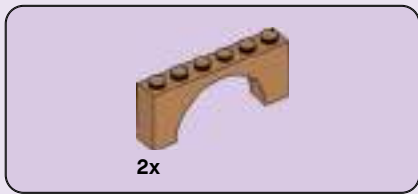

44



2x  1x 

45





46





2x

47





48



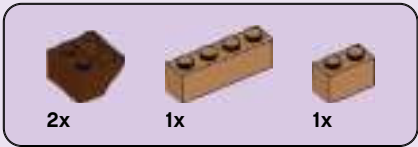

49



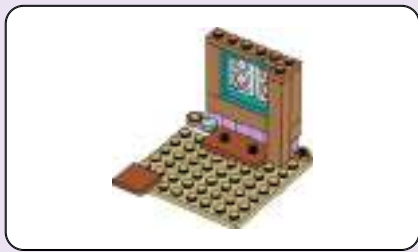

50



51

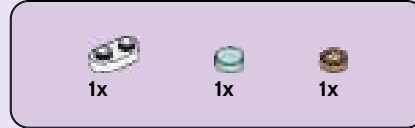

52

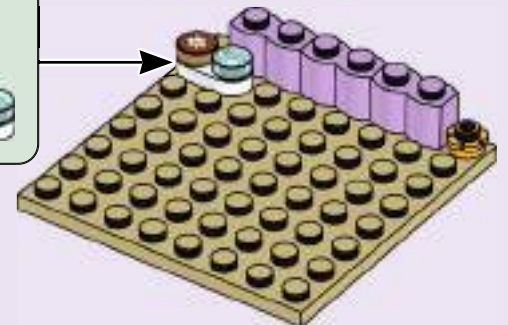

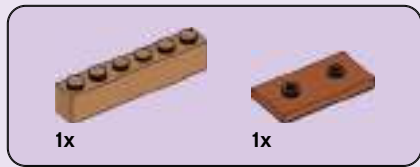

53

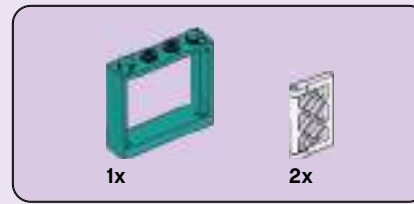

54

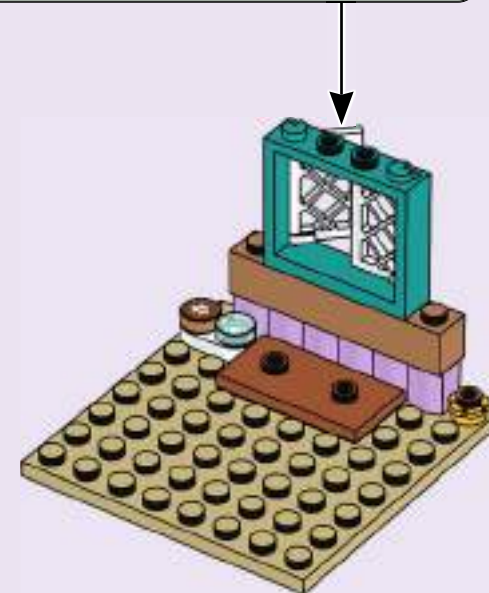
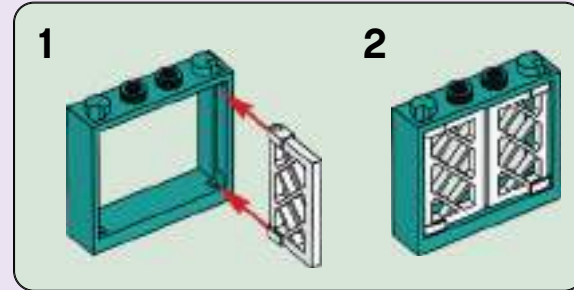

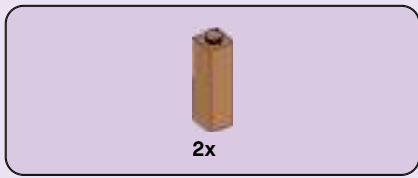

55

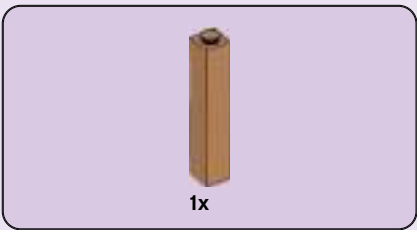

56





57



58



59



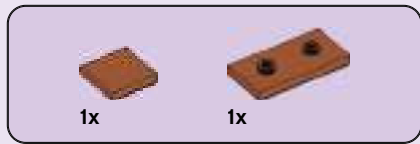

60



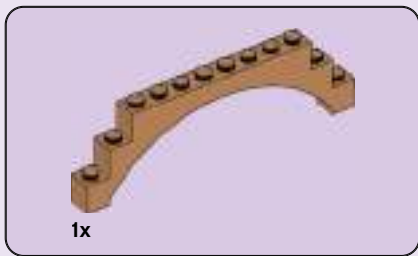

61





1x



1x

62





63



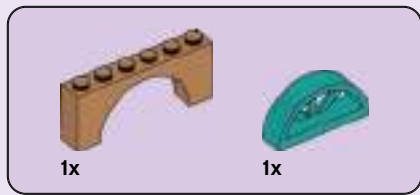

64



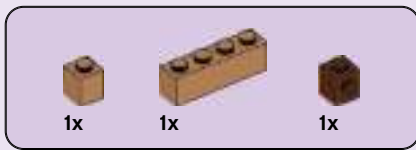

65





2x

66



2x



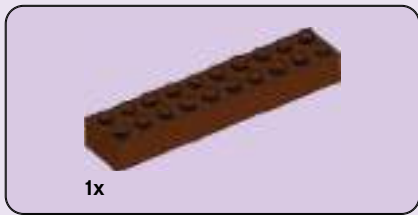

67





2x



2x

68



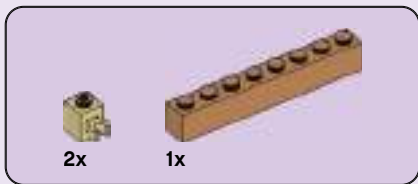

69



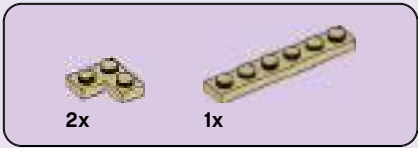

70





4x

71



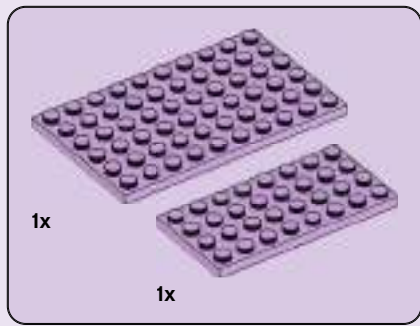

72



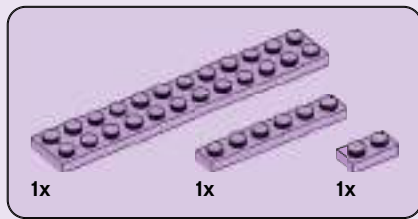

73





4x

74



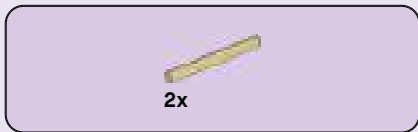

75





2x

76



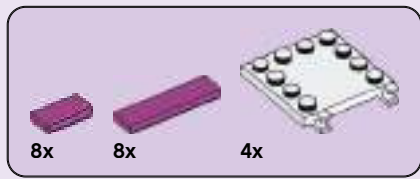

77

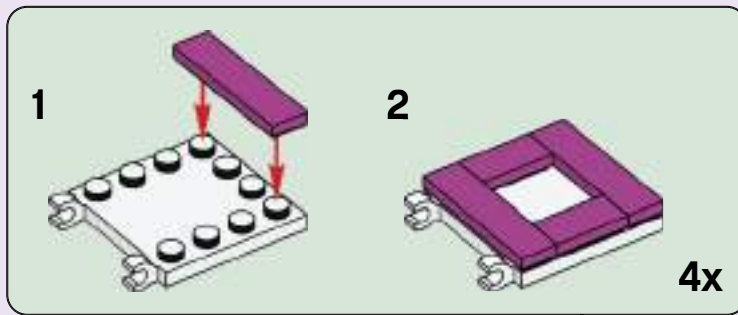





78





1x



1x

79





80





1x



1x

81





82

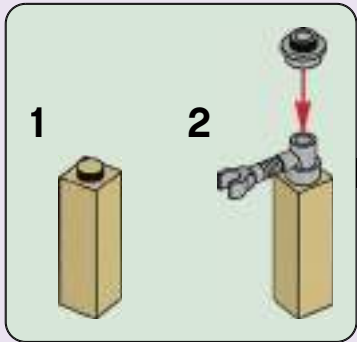

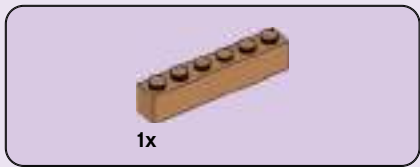

83





84



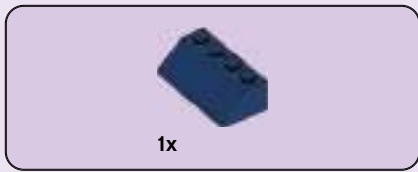

85



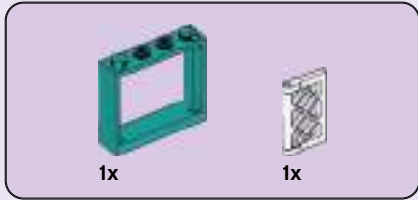

86

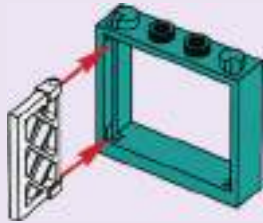

87

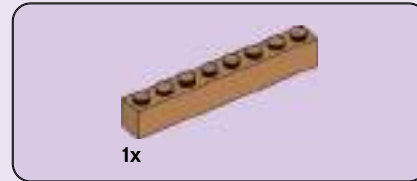
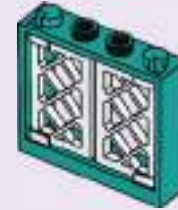

88

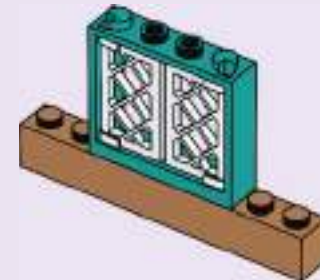



2x

89

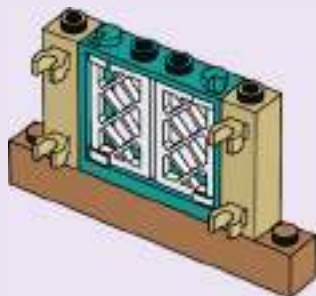

1x

90

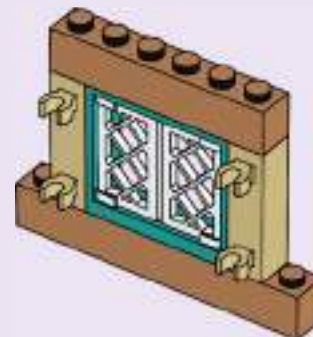

1x



1x

91

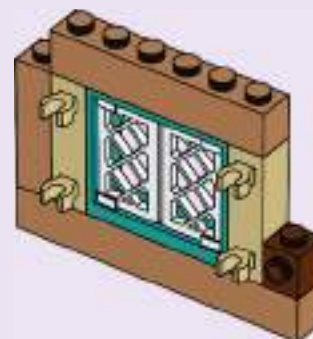



2x

92

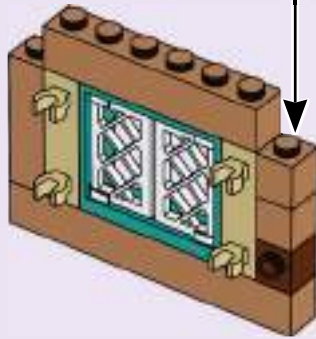
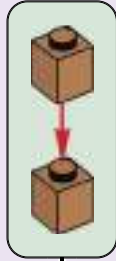

2x

93

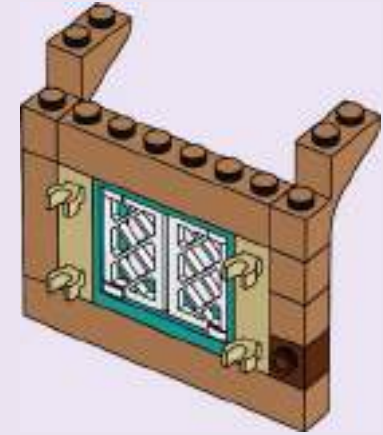

2x

94



95



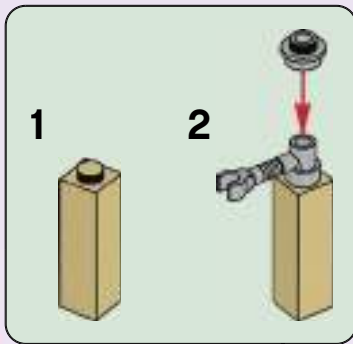

96



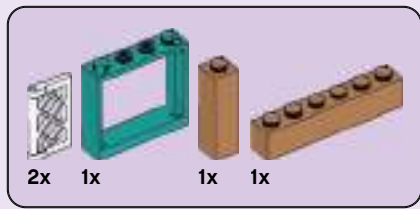

97

1

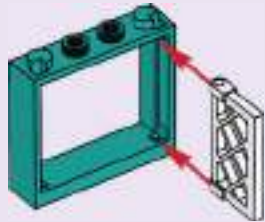

2

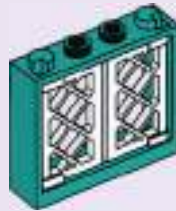

3

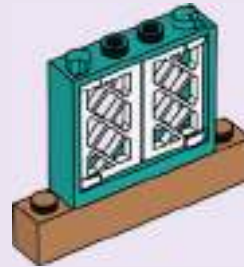

4

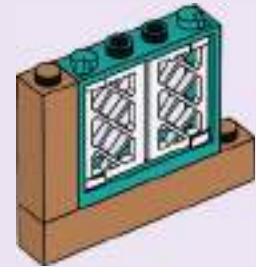





98

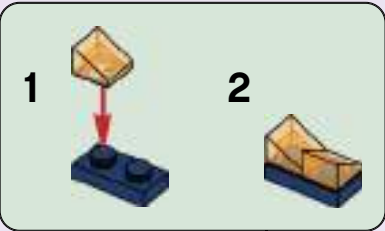



99

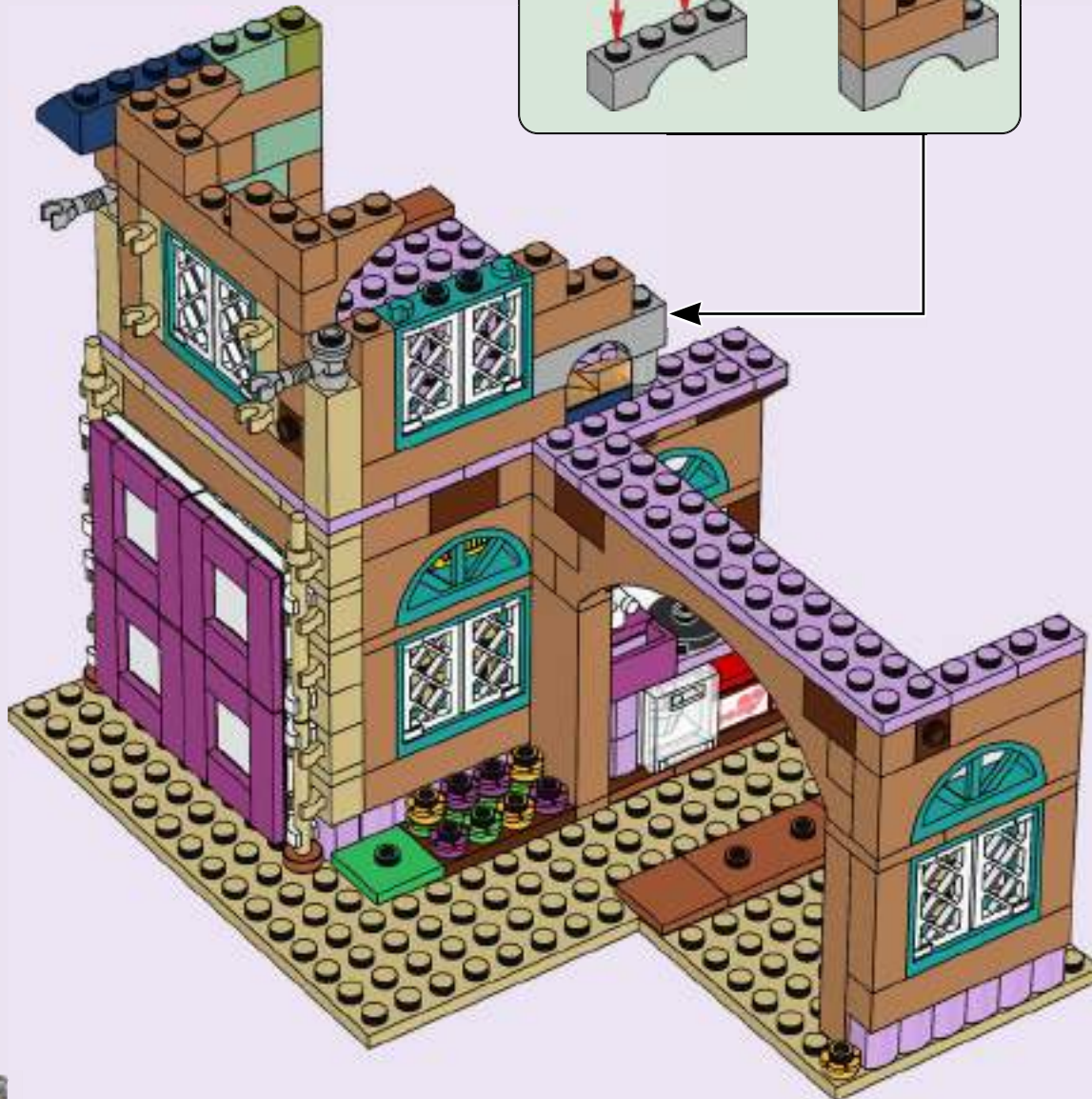
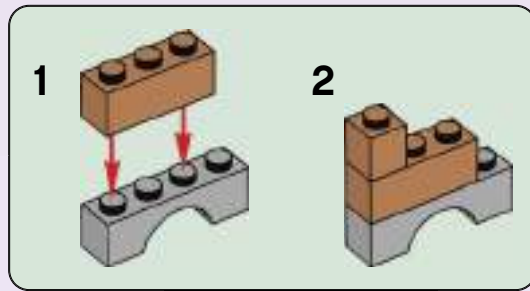



1x



1x

100



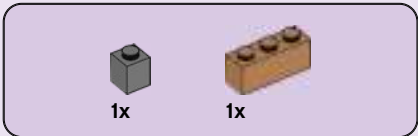

101



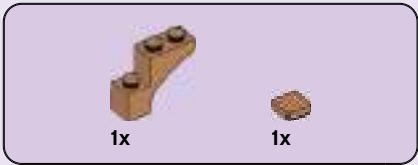

102





103





1x

104





105

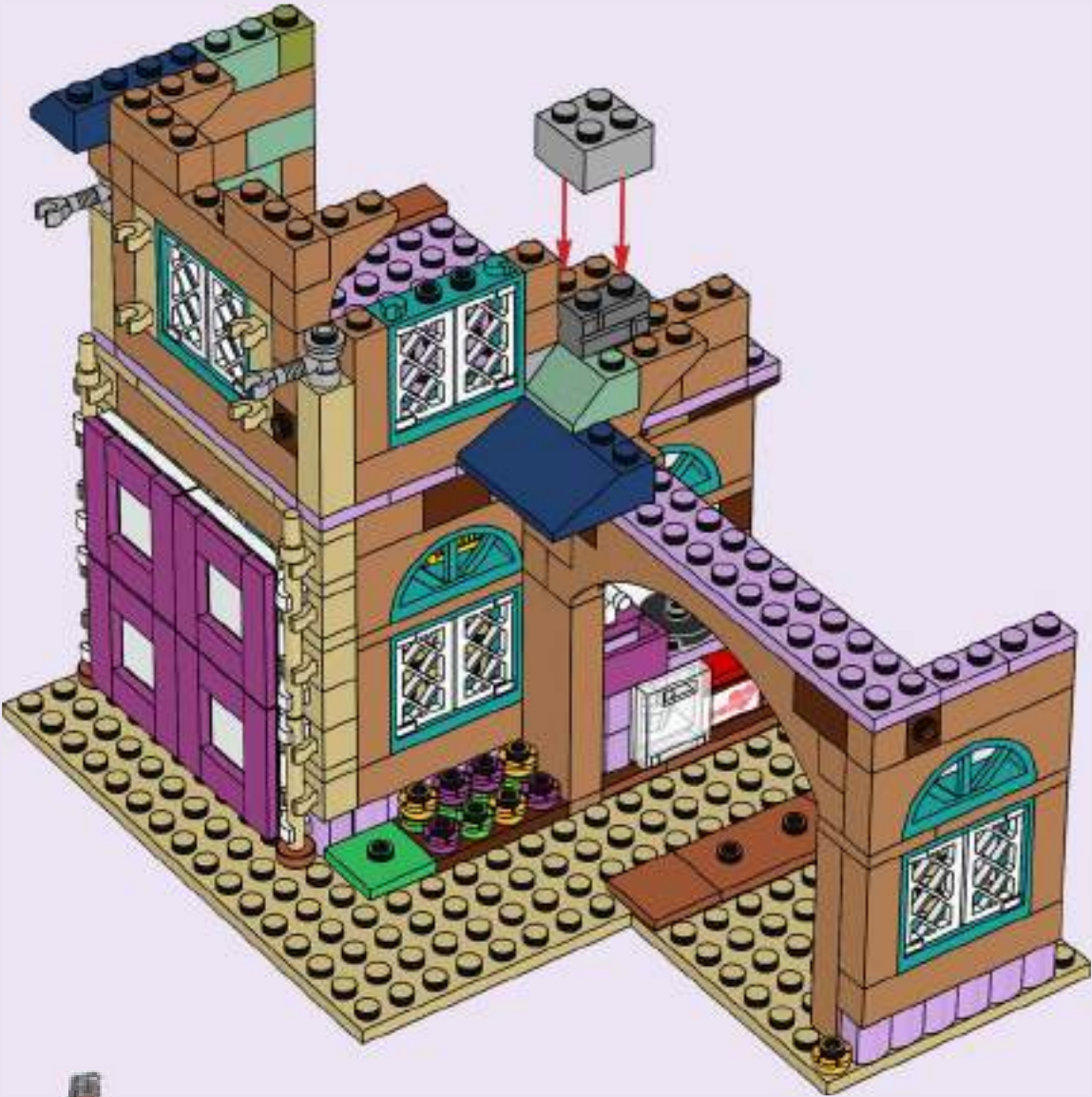

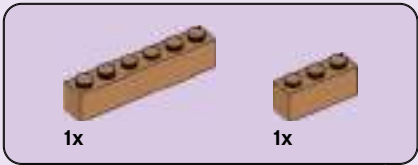

106





107

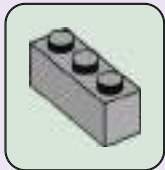



2x



1x

108





1x

109

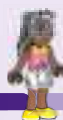



1x

110





111





112





113



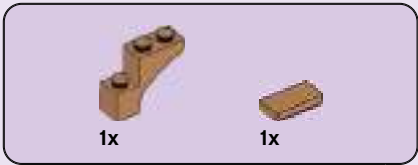

114





115



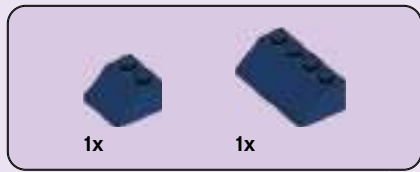

116





117



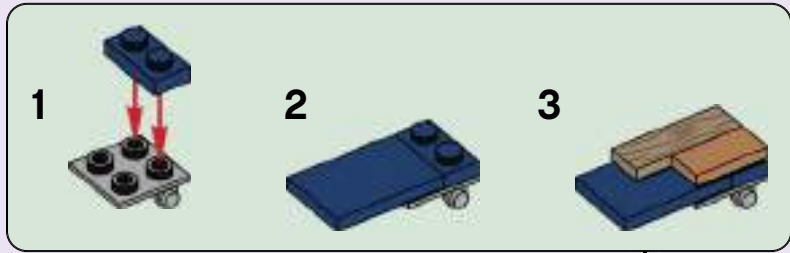

118



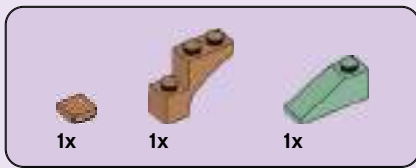

119



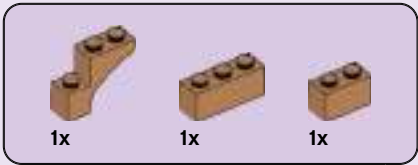

120





121





1x



1x

122





123





124





125



126



127

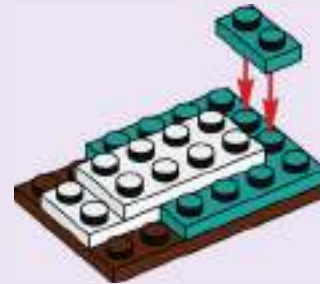

128





4x

129



1x

130

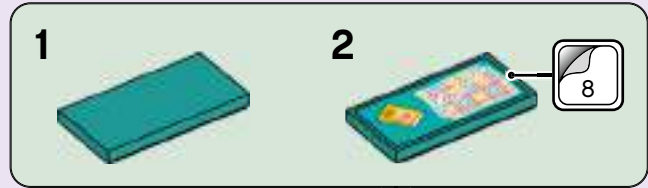

2x

131





1x

132



1x

133

1



2



2x



2x



2x

134

1



2



2x

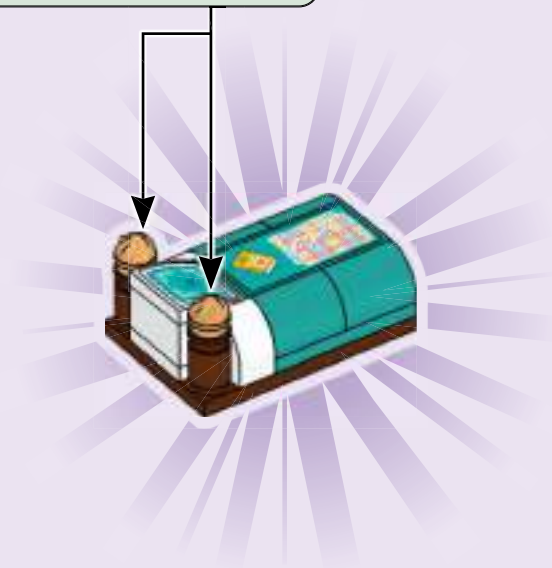

135





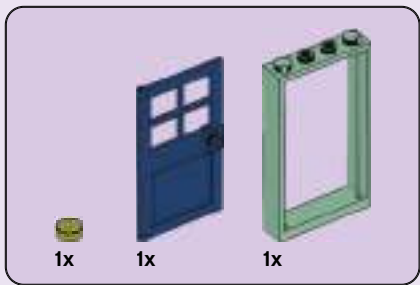

136

1

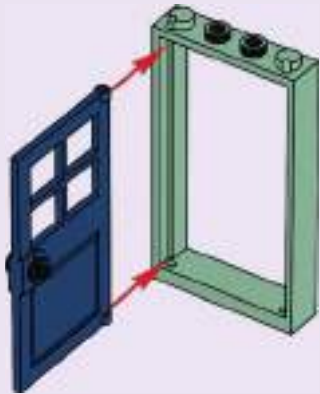

2



3

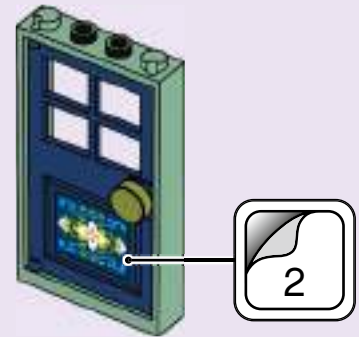

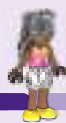

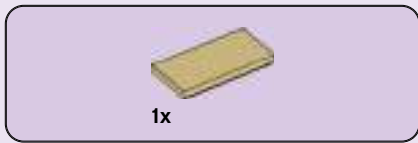

137

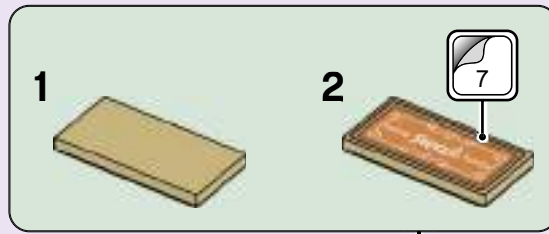

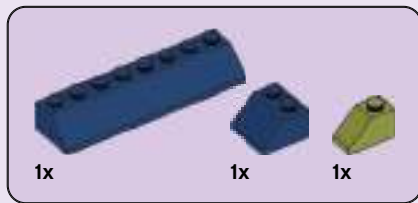

138





139



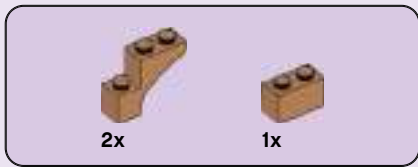

140

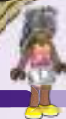



4x



1x

141



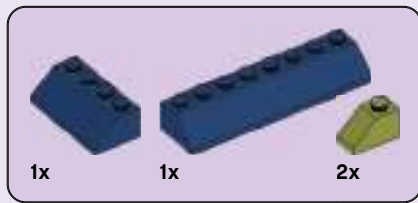

142

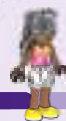



1x



2x



2x

143





144



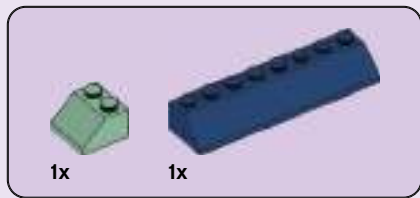

145





146





147





2x

148





1x

149



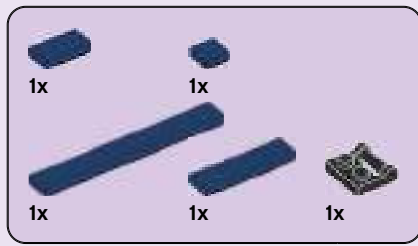

150





151





152

1

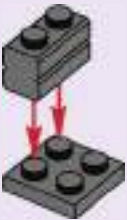

2



3



4



5



6



7





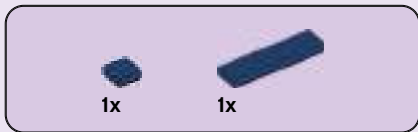

153





154

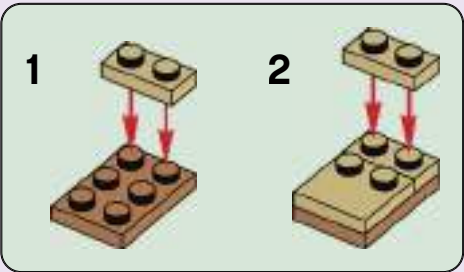

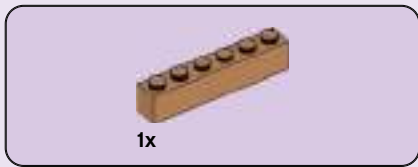

155





156



1x  2x 

157





2x



1x

158





159

1

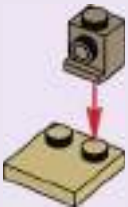

2



3



4





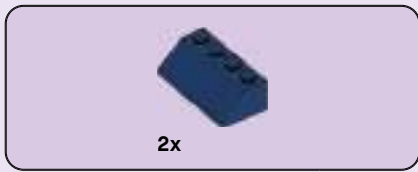

160





1x

162



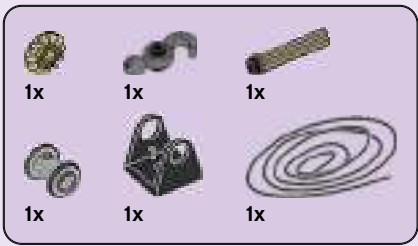

163

1



2



3

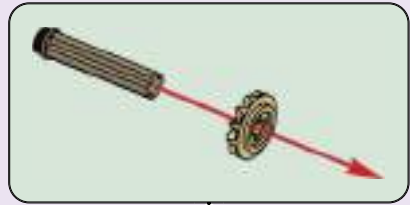

4









164



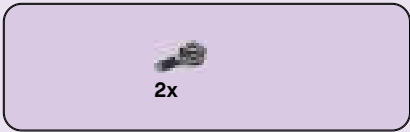

165





166

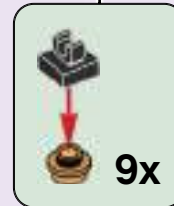



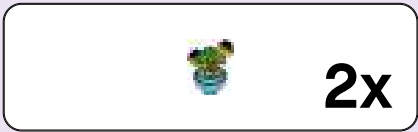



167





		
1x	1x	1x

168

	
1	2





169





170



171



172





1x

173



1x



1x

174



2x



1x

175

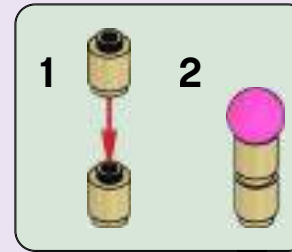

176

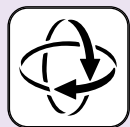



3x



1x

177



3x

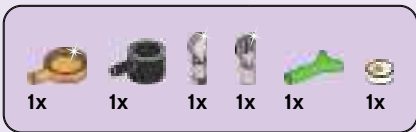

178





179



180



181





182



183

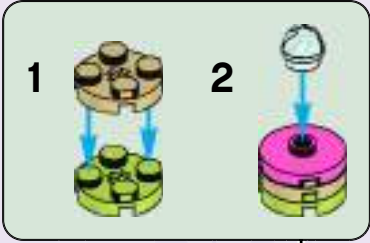





1x

185



2x

186



2x

4x

187



2x

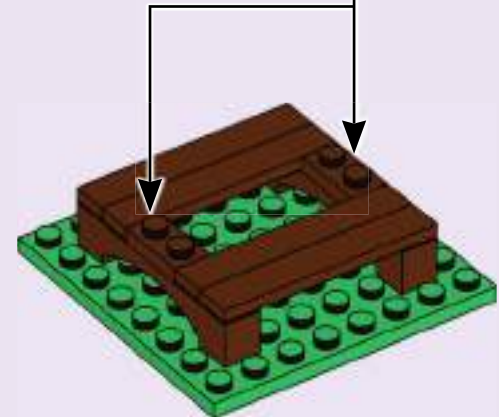



2x

188



1x

189



1x



1x



2x

190



1x



1x



2x



2x

191





192



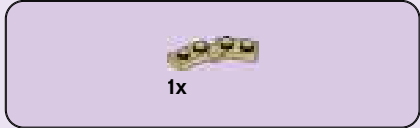

1



2

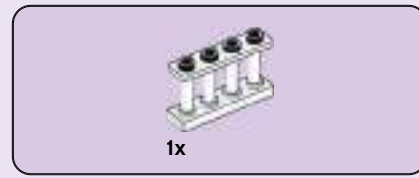

3

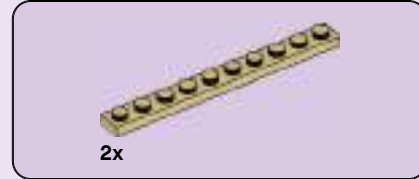

4

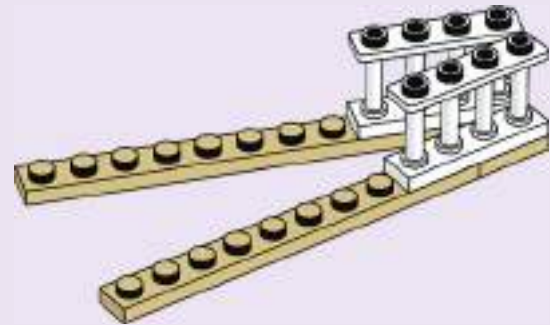

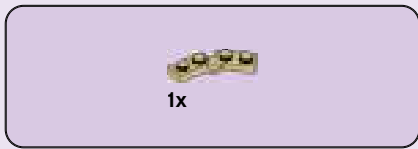

5

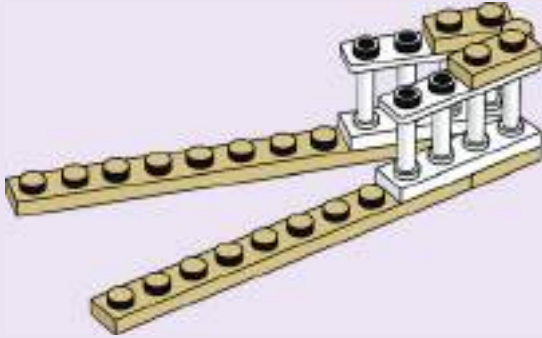

6

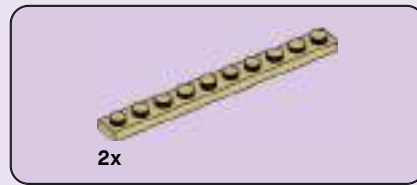
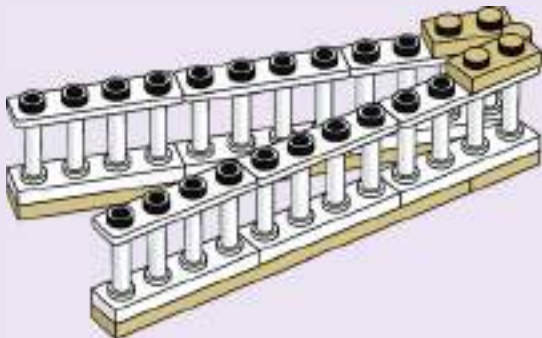

7

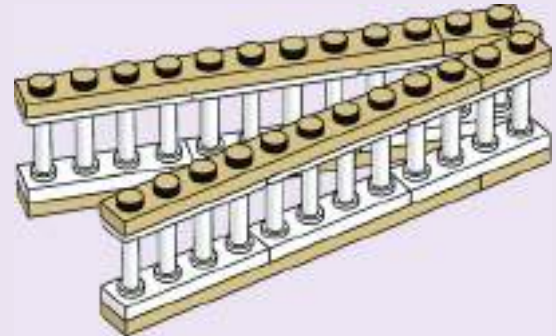

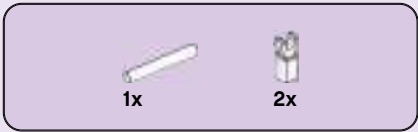

8

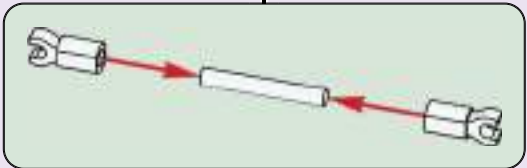
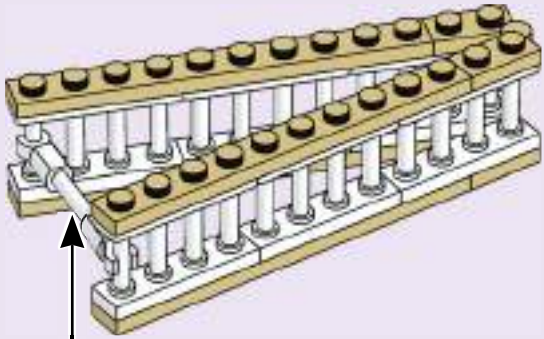

9



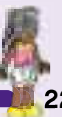



Friends™



41716



41711



41717



41714



41713

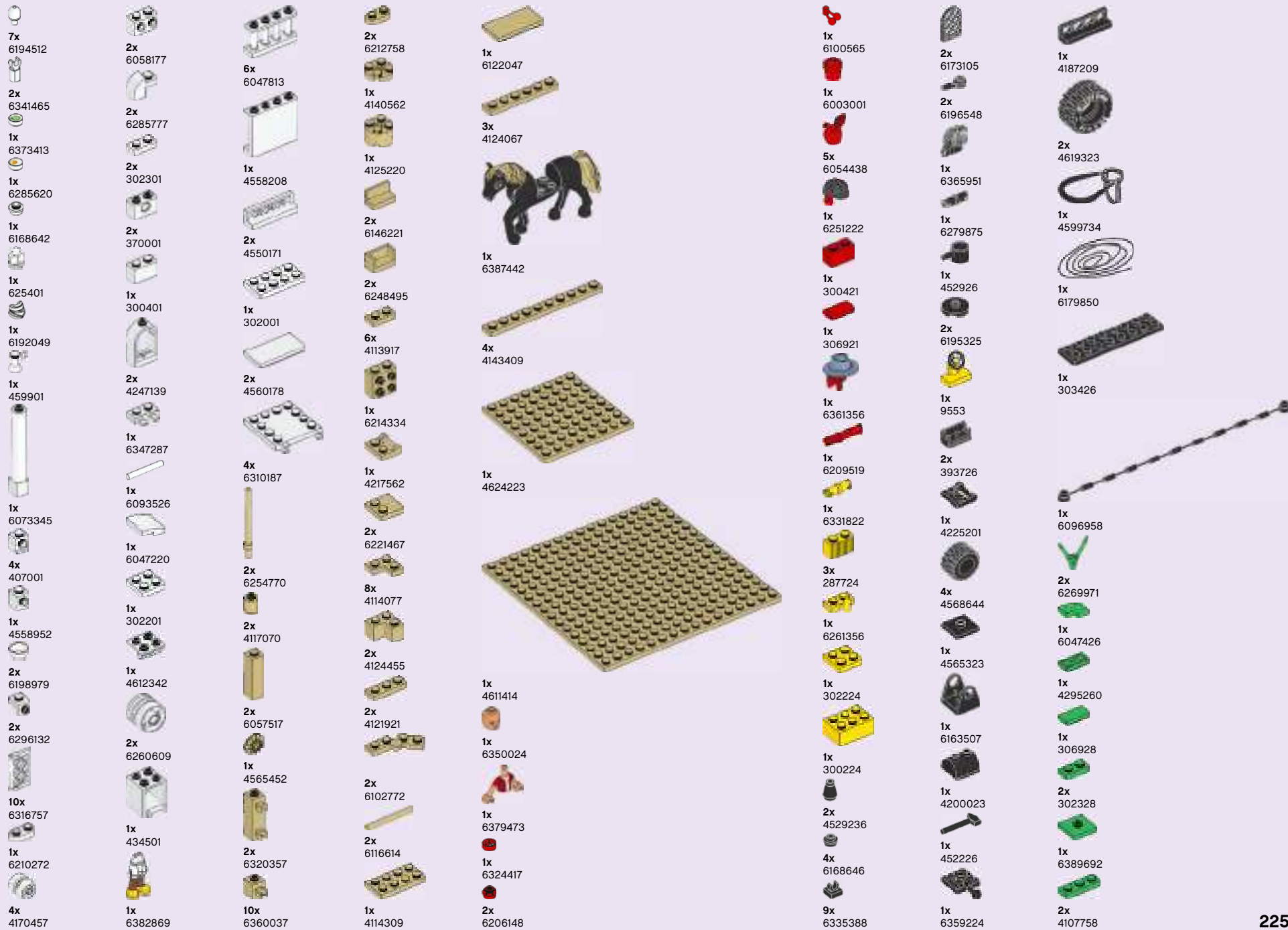

- 2x 6268814
- 2x 302028
- 1x 6097413
- 1x 6133767
- 1x 4277361
- 1x 6345559
- 1x 4161677
- 9x 6206150
- 1x 4107050
- 2x 6235080
- 1x 6182261
- 2x 4119479

- 1x 6389695
- 3x 6266964
- 2x 6322840
- 1x 6319680
- 2x 4666352
- 6x 4614158
- 3x 6186423
- 6x 6288614
- 1x 6238856
- 1x 6247357
- 2x 6258607
- 2x 6247792
- 4x 6240225
- 1x 6274739
- 2x 6247795
- 2x 6247788

- 1x 6103249
- 4x 6345262
- 1x 6213777
- 1x 6277496
- 4x 6393296
- 5x 6222972
- 3x 6338181
- 1x 6223065
- 1x 6254100
- 3x 6247796
- 1x 6240553
- 1x 6284583
- 1x 6087084
- 1x 6314224

- 6x 6209682
- 1x 6248482
- 1x 6101073
- 8x 4611415
- 2x 6325956
- 8x 6078305
- 1x 6330565
- 1x 6414568
- 2x 6273590
- 1x 4598955
- 1x 6031821
- 2x 6329820
- 1x 6015452
- 1x 6414512
- 2x 6310832

3.2

- 3x 4631385
- 2x 4528488
- 2x 6092588
- 3x 4528981
- 1x 6103405
- 9x 4153653
- 1x 6186576
- 1x 6186974
- 3x 6103985
- 15x 4578094
- 1x 6331690
- 2x 4667595
- 3x 6036241

- 1x 4507080
- 4x 6239765
- 1x 4616578
- 2x 4616581
- 8x 6083972
- 1x 4598531
- 1x 6342692
- 2x 6245265
- 1x 6240550
- 17x 6209681
- 2x 6370534
- 1x 6279767
- 1x 4243920

- 1x 6170468
- 4x 4211183
- 4x 6215659
- 2x 6348057
- 1x 4504376
- 2x 6062574
- 1x 6170570
- 1x 6153863
- 4x 4211180
- 2x 4270470
- 1x 4211222
- 2x 4211150
- 1x 4224243
- 2x 4645103
- 1x 6338135

- 1x 4211200
- 4x 4211221
- 1x 4211257
- 1x 4520638
- 1x 4211152
- 3x 6055086
- 1x 4211197
- 1x 4211194
- 1x 4211157
- 2x 4211186
- 1x 4211201
- 4x 4211204
- 3x 4655611

- 1x 6270119
- 5x 4211247
- 1x 4271874
- 1x 4277751
- 1x 6096716
- 1x 4211412
- 1x 4529241
- 4x 6168647
- 3x 6250597
- 4x 4211476
- 1x 4514195
- 1x 4211370

- 1x 4211469
- 1x 6146223
- 2x 6066097
- 2x 4211644
- 1x 6319336
- 2x 4211376
- 1x 4211349
- 2x 4211881
- 2x 4211387
- 1x 6273227
- 1x 4211428
- 1x 6230234
- 1x 4211435
- 2x 6387244

 1x 4211395	 1x 6211334	 1x 6350643	 1x 6186400	 1x 6102995	 2x 6132411	 4x 6209673	 1x 6284595
 1x 6408542	 1x 6211336	 1x 6265670	 1x 6347306	 9x 6099341	 1x 6133911	 1x 6097053	 9x 6064670
 1x 6209679	 3x 6092604	 6x 6300103	 4x 6056383	 3x 6295464	 2x 4625032	 17x 6393295	 2x 6050916
 1x 6228091	 2x 6174640	 1x 6287856	 1x 6177535	 4x 6106193	 1x 6060857	 11x 6099190	 11x 6190252
 1x 6096094	 1x 6384649	 28x 6057986	 15x 6192922	 1x 6313600	 4x 4619521	 1x 6099349	 1x 6245278
 1x 6223767	 2x 4225142	 6x 6177146	 16x 4568955	 2x 6396749	 2x 6152645	 2x 6099355	 1x 6138068
 1x 4211098	 3x 6167464	 6x 6378362	 1x 6334099	 2x 6396749	 2x 6411359	 1x 6204071	 1x 6138068
 3x 6000311	 1x 6324732	 1x 6339311	 1x 6167700	 1x 6393297	 4x 4619512	 1x 6204114	 1x 6373424
 1x 4211135	 1x 6242568	 1x 6138279	 2x 6223183	 2x 6174192	 3x 6177195	 1x 6273909	 1x 6390762
 1x 6347464	 1x 6278490	 2x 4651231	 2x 6174192	 2x 6361354	 1x 6173813	 1x 6334051	
 2x 4211094	 1x 6394025	 21x 4569382	 2x 6021997	 2x 6196796	 1x 6356469		
 1x 4210702	 1x 6351619	 2x 6021997	 2x 6344931	 3x 4619524	 1x 6173813		
 1x 6249118	 1x 6287844	 1x 6218360	 1x 6035734	 1x 4619636	 2x 4625027		
 1x 6361352	 1x 6060795	 3x 6058135					

Customer Service
Kundenservice
Service Client
Assistenza clienti
Atención al cliente
Serviço de Apoio ao Consumidor
Ügyfélszolgálat
Klientu apkalpošanas dienests
Serviciul pentru clienți
客户服务
コンシューマーサービス
고객 서비스
LEGO.com/service



Scan this QR code or go to **LEGO.COM/PRODUCTFEEDBACK** and give us your short feedback about this LEGO® set for a chance to win a cool LEGO prize.



WIN

Terms & Conditions apply

GEWINNE

Scanne diesen QR-Code oder geh auf LEGO.COM/PRODUCTFEEDBACK

und gib uns dein kurzes Feedback zu diesem LEGO® Set. Dann hast du die Chance, einen coolen LEGO Preis zu gewinnen.

Es gelten die Teilnahmebedingungen

GAGNE

Scannez ce code QR ou rendez-vous sur LEGO.COM/PRODUCTFEEDBACK

pour donner votre avis sur ce produit LEGO® et avoir une chance de gagner un prix LEGO.

Voir Conditions Générales

GANAN

Escanea este código QR o visita LEGO.COM/PRODUCTFEEDBACK

y comparte con nosotros tu opinión sobre este set LEGO® para tener la oportunidad de ganar un fantástico premio LEGO.

Términos y Condiciones aplicables

获取奖品

只需扫描此二维码或访问 LEGO.COM/PRODUCTFEEDBACK,

就这款乐高®套装提供简短反馈, 就有机会赢得很酷的乐高奖品。

《条款及条件》适用

경품 당첨 기회

이 QR 코드를 스캔하거나 LEGO.COM/PRODUCTFEEDBACK

페이지에 접속하여 이 레고® 세트에 대한 간략한 피드백을 적어주시고, 멋진 레고 상품을 받을 기회를 잡으세요.

약관 적용

ЗАПОЛНИ АНКЕТУ И ПОЛУЧИ ПРИЗ

Отсканируйте этот код или перейдите на веб-сайт LEGO.COM/PRODUCTFEEDBACK,

чтобы оставить краткий отзыв об этом наборе LEGO® и выиграть крутой приз LEGO.

Применяются Условия и правила участия